

Endura Simple Corner

Installation Instructions

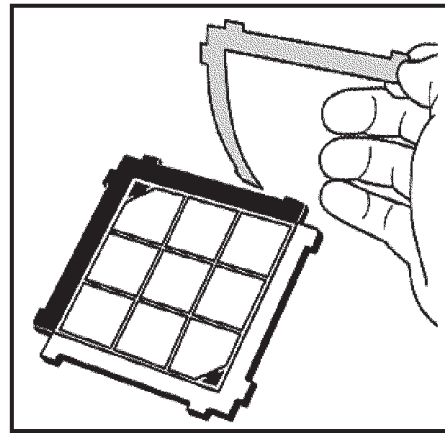

STEP ONE: REMOVE PAPER BACKING

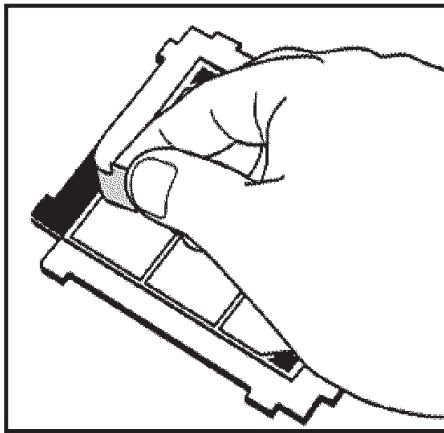

Peel protective paper off of the backside (instruction side) of the applicator in the location marked "CORNER A" to reveal the adhesive underneath.

 **Do not remove instructions**

STEP TWO: INSTALL INTO FIRST CORNER

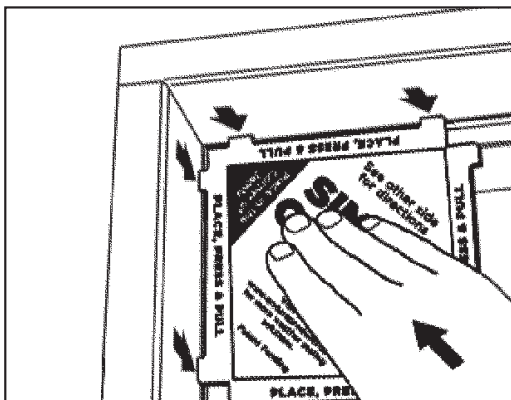

a. Peel back the weatherstrip from the header and jamb in the corner where you are working. Position the pad in an upper corner of the frame so that the tab-like protrusions meet the jamb & header.

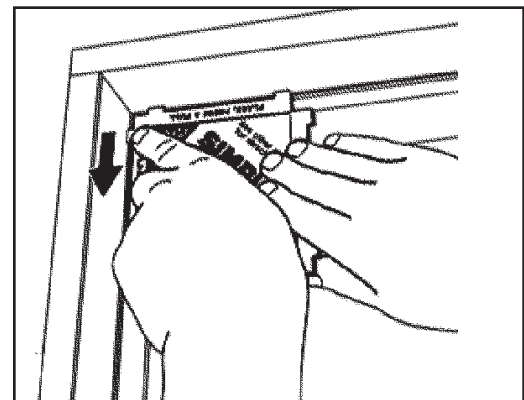

b. Once aligned - press pad firmly onto rabbet stop of the side jamb and head jamb to fully adhere the part to the jamb surface.

 **Be careful that the adhesive doesn't touch the side jambs.**

STEP TWO (CONT.): INSTALL INTO FIRST CORNER

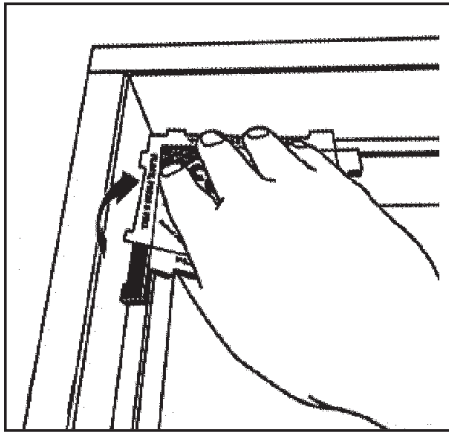

c. Grip the applicator firmly and peel back from the framework to reveal the gasket strip.

 **Do not discard the applicator until the second corner gasket is applied.**

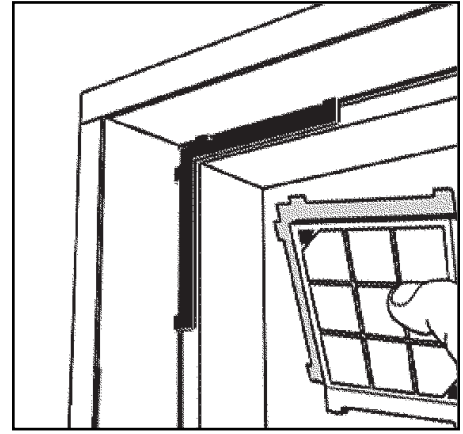

d. The gasket strips should now be exposed and affixed to the upper corners of the frame.

STEP THREE: FINISH INSTALL AND REPEAT

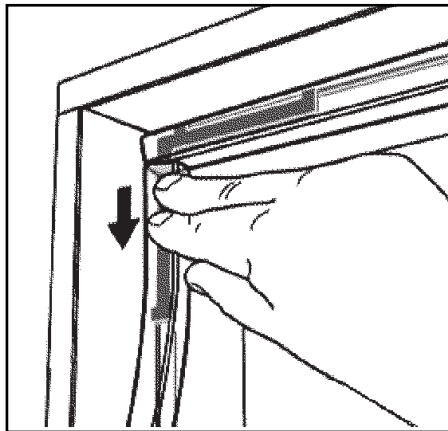

Insert the head jamb and side jamb weatherstrip as normal. Repeat process for other corner.

