

OVERVIEW

TOOLS REQUIRED

- Drill
- 1/4" Drill Bit
- Phillips Screwdriver

PARTS INCLUDED

1. Assembled Interior Escutcheon
2. Assembled Exterior Escutcheon
3. (2) Keys
4. (2) Mounting Screws

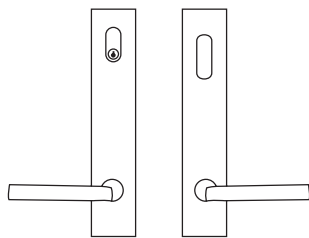

Modern
Escutcheon

1- 11/16" Crossbore

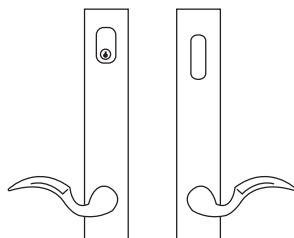

Rectangular
Escutcheon

1- 11/16" Crossbore

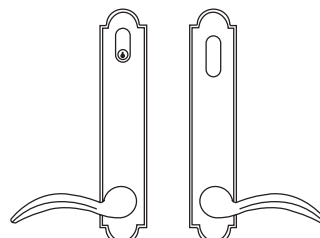

Arched
Escutcheon

1- 11/16" Crossbore

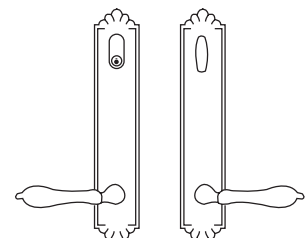

Tuscany
Escutcheon

1- 11/16" Crossbore

1. Verify lock readiness

- Door panel should be open. If not, rotate interior lever actuator hub with flathead screwdriver, turning away from the edge of the door panel.
- Ensure deadbolt slot is in vertical (unlocked) position.
- Ensure latches are in latched position. The latches should be so they can be easily pushed in by hand.
- If the latches cannot be pushed in, disengage deadbolt feature by rotating the deadbolt drive slot, turning away from the edge of the door panel.

 Use the key cylinder tailpiece - Do not use a screwdriver.

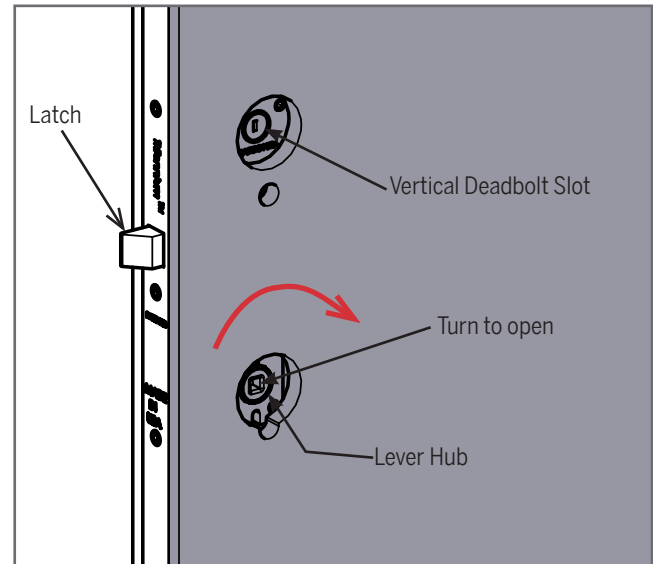

2. Escutcheon Installation

A. Install exterior escutcheon first, and then hold in place. Ensure that:

- The key cylinder tailpiece projects through the deadbolt hub slot.
- The spindle mates to the lever hub.

B. Install the interior escutcheon next. Ensure that:

- The key cylinder tailpiece mates with the thumbturn slot.
- The spindle mates to the lever hub.

C. Secure plates by inserting two mounting screws and tightening by hand.

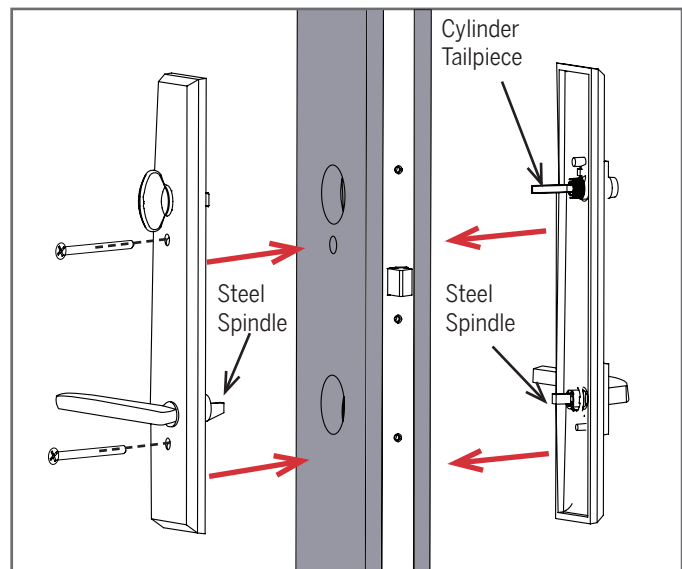

D. Verify Lock and Handle Operation

- Rotate thumbturn 90° towards the door edge. Latches should extend to deadbolted position. Rotate the thumbturn 90° the other direction. The latch bolts should retract to original position.
- Rotate thumbturn 90° towards the door edge again. Latch bolts should extend to deadbolted position.
- Operate exterior lever downward. The lever should not turn and the latch bolts should remain in deadbolted position.
- Operate interior lever downward. The latch bolts should fully retract.
- Operate exterior lever. The latch bolts should fully retract.

3. Strike Plate Assembly

Parts Required

- (3) Dust Boxes
- (3) Reinforcing Plates
- (3) Strike Plates
- (6) 3/4" screws
- (3) #10 x 2-1/2" screws

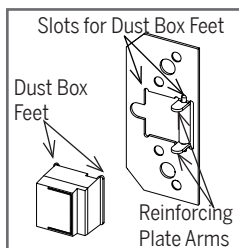

- The Dust Box Feet should align with the slots in the reinforcing plate.
- The reinforcing plate arms should sit inside the dust box.

A. Attach strike plates to jamb.

- Attach the dust box to the reinforcing plate.
- Align the 3 holes on the strike plate with the reinforcing plate.
- Orient as shown.
- Use 3/4" screws in top and bottom holes of each strike.
- Use a long #10 x 2-1/2" screw in center hole. (The purpose is to anchor each strike plate to the structural framing for added security.)
- Repeat for remaining strike locations.

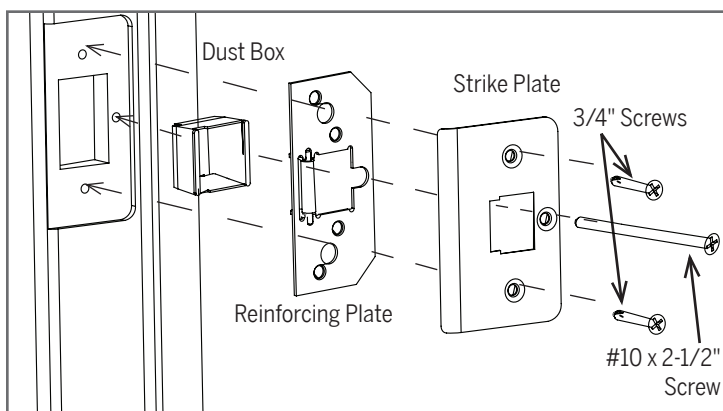

Note

A 1/8"Ø pilot hole should be drilled into the rough framing for the long screw.

Note

Solid shimming should be placed behind the jamb at each strike location to allow for firm anchoring to structure.

4. Final Operation Check

- Close the door.
- Repeat steps described in Step 2D.