

# Z-Articulating Cap Sill<sup>®</sup> Cap Cover

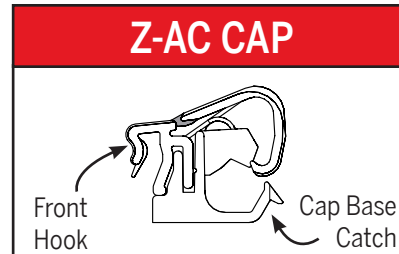

8817 West Market Street, Colfax, NC 27235  
800.334.2006 Fax: 336.668.4478  
www.enduraproducts.com

## Replacement Instructions

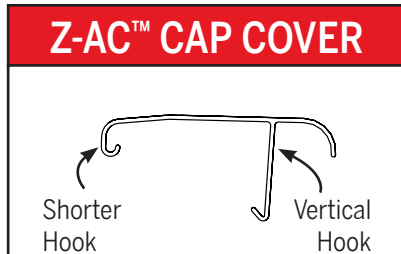

### STEP 1: PLACE THE CAP COVER OVER THE SILL CAP

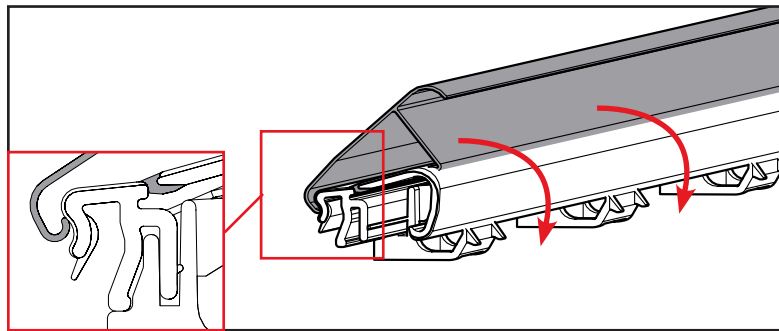

a. Starting at one end, engage the smaller hook of the cap cover with the shorter hook of the Z-AC cap. Press down along the length of the cap to ensure the cover securely fits into the front hook of the cap.

### STEP 2: PRESS DOWN AND SECURE CAP COVER

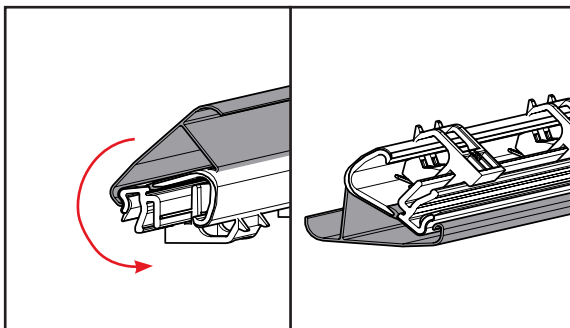

a. With the front hook still engaged, turn the cap over so the bottom of the spring-loaded bases are exposed.

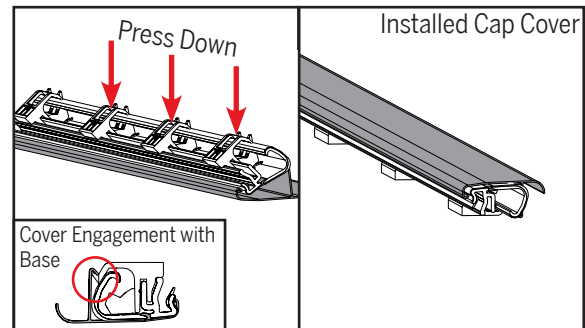

b. Press down on each base, compressing the cap, to connect the vertical hook to the catch on the center base.