

# Bumper Outswing Sill Cap Replacement Instructions

8817 West Market Street  
Colfax, NC 27235  
800.334.2006  
www.enduraproducts.com



## Product Description and Reference Guide

### Inswing and Outswing Sills

- A: Inswing:** Door swings into home when opened. Cap is thinner than outswing cap. Door sits on top of cap when closed.
- B: Outswing:** Door swings away from home when opened. Cap is wider than inswing cap. Door sits against side of cap when closed.

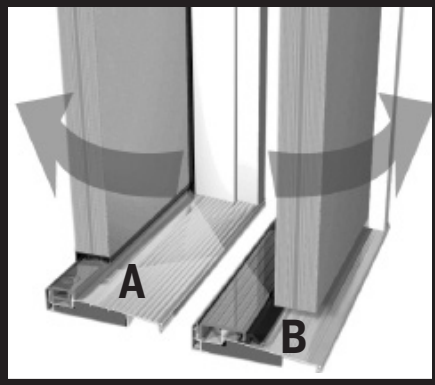

### Endura Sill With Bumper Outswing Sill Cap

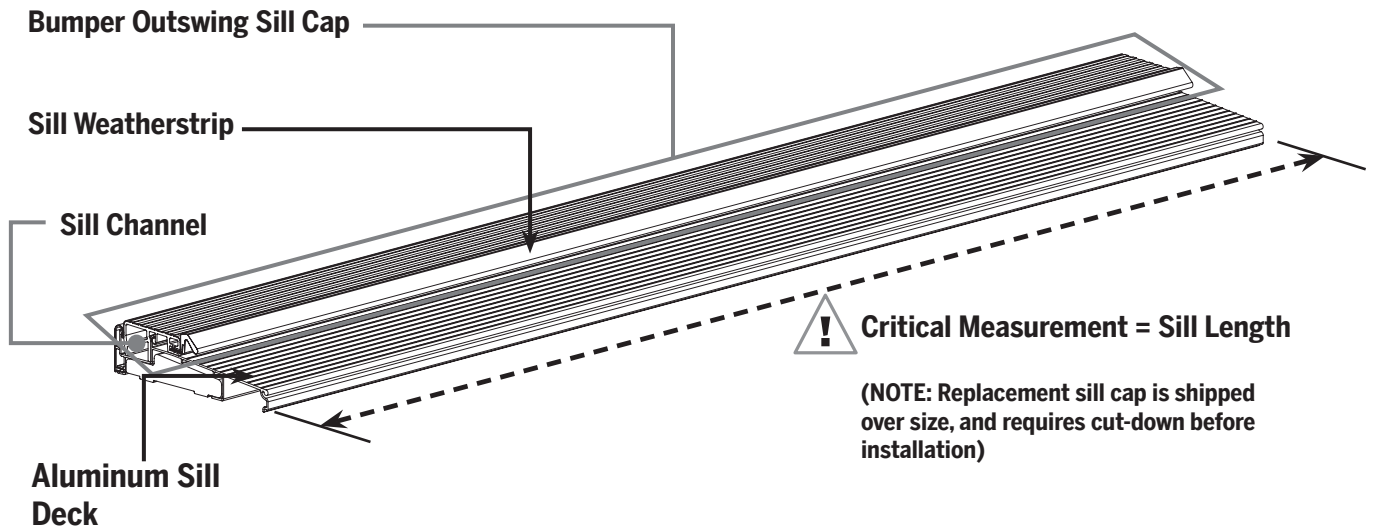

# Bumper Outswing Sill Cap Replacement Instructions

8817 West Market Street  
Colfax, NC 27235  
800.334.2006  
www.enduraproducts.com



## Required Tools

1. **Flathead Screw Driver:** to pry off old sill cap.
2. **Thin Board or Cloth:** to protect aluminum sill deck.
3. **Measuring Tape:** for sizing new sill cap before cutting to size.
4. **Cutting Tool:** blade or small saw to trim cap to size.

## 1 Remove Old Sill Cap

a) To prevent damage, carefully remove weatherstrip from front of sill cap.

⚠️ Protect aluminum sill deck with a thin board or cloth to prevent damage when prying off sill cap.

b) Place a flathead screwdriver under front leg of sill cap at one end.

c) Pry old sill cap up with screwdriver, working from one end to the other.

d) Pull cap out of channel.

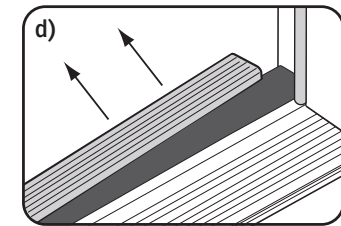
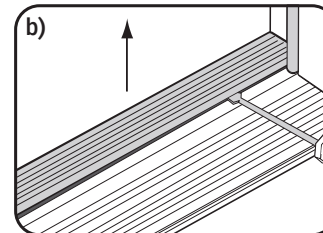
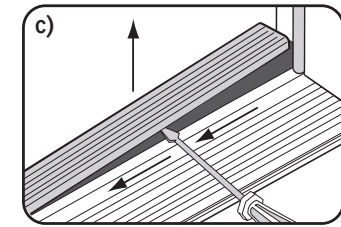
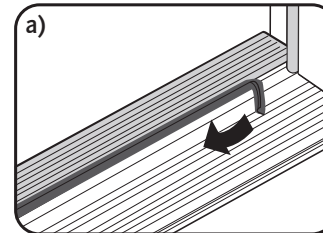

## 2 Cut New Sill Cap to Length

a) Remove the weatherstrip from the new sill cap to prevent damage.

b) Measure length of sill channel to determine new sill cap length.

c) Cut other end of new sill cap to length proper length with sill channel measurement.

d) Trim the weatherstrip to match the length of the new trim cap.

⚠️ **CAUTION:** Measure carefully and cut precisely to avoid damaging the NEW cap.

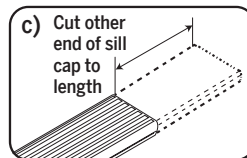
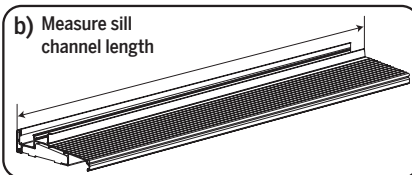
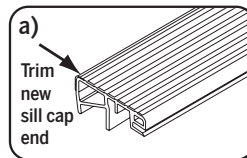

## 3 Assemble New Sill Cap and Weatherstrip

a) Reinsert the weatherstrip into the sill cap.

b) Align one end of sill cap with jamb face.

c) Push sill cap firmly into sill channel.

d) Work along sill cap length until fully seated (secured in sill channel).

e) Ensure weatherstrip and sill cap fit securely.

