

20-Minute Fire-Rated Frame

Installation Instructions

(FrameSaver® FusionFrame™)



8817 West Market Street
 Colfax, NC 27235 | 800.334.2006
 www.enduraproducts.com

NOTES:

- **Door Unit Maximum Sizes Allowed:**
 - Single Door = 3'0" Wide x 8'0" High
 - Double Door = 6'0" Wide x 8'0" High
- **Hinges:**
 - Hinges must comply with NFPA 80

STEP 1: FASTEN FRAME AND CASING (AT JAMBS AND HEADER) TO ROUGH OPENING



Note the requirements on gap size between the back of jamb and header, and face of rough opening stud. Note requirements on nail size, location and quantity.

ONE PIECE FUSIONFRAME

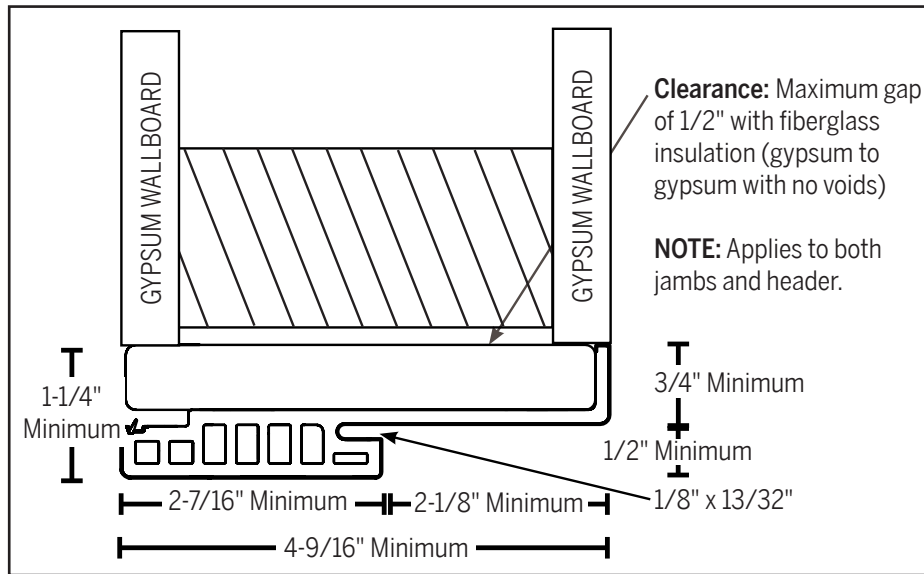

TWO PIECE FUSIONFRAME

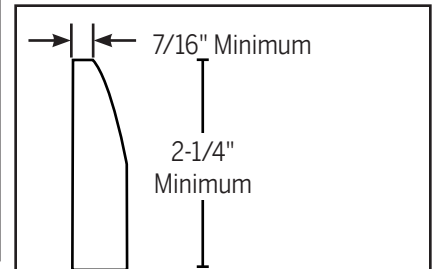
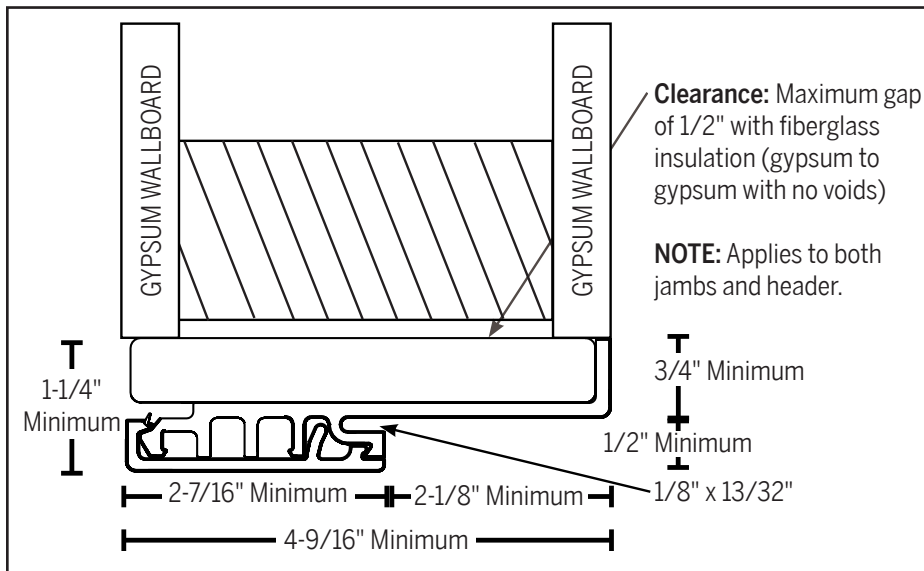

Casing/Trim/Brickmould:

- Attach with 6d Finishing Nails, 16" On Center
- Required on interior and exterior sides of unit
- Pine (Solid or finger-jointed) or other wood of equal or greater density allowed.

STEP 2: PLACE SHIMS

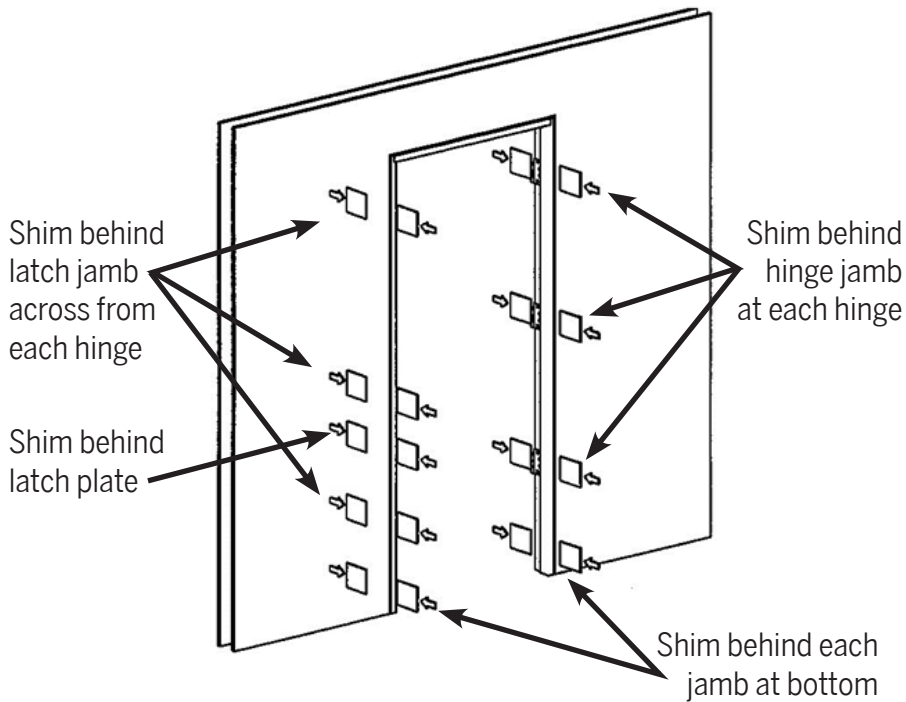

Hinge Screws – At each hinge use the following fasteners:

- (2) # 12 x 1-1/4" wood screws – place in holes closest to edge of jamb
- (2) # 12 x 2-1/2" wood screws – place in holes closest to center of jamb

Latch Plate Screws – Use the following fasteners:

- (2) # 8 x 2-1/2" wood screws

STEP 3: SECURE SHIMS

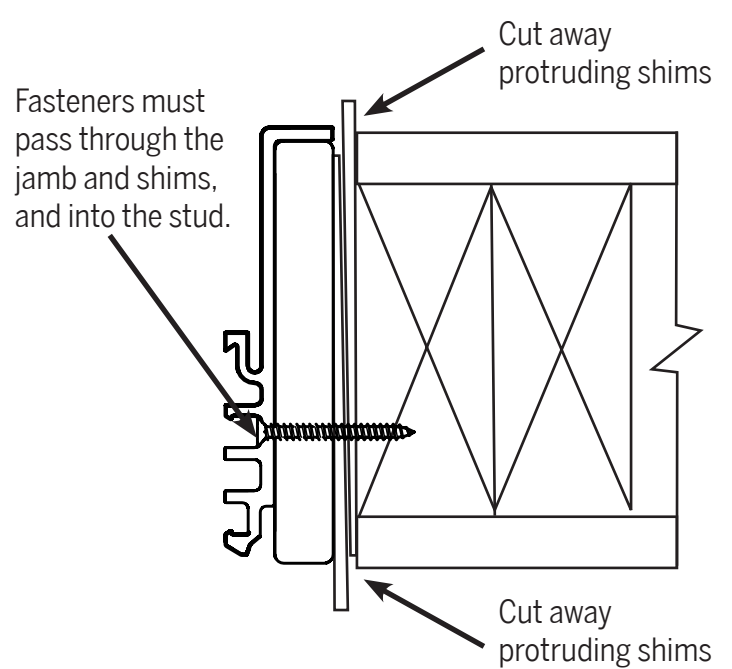
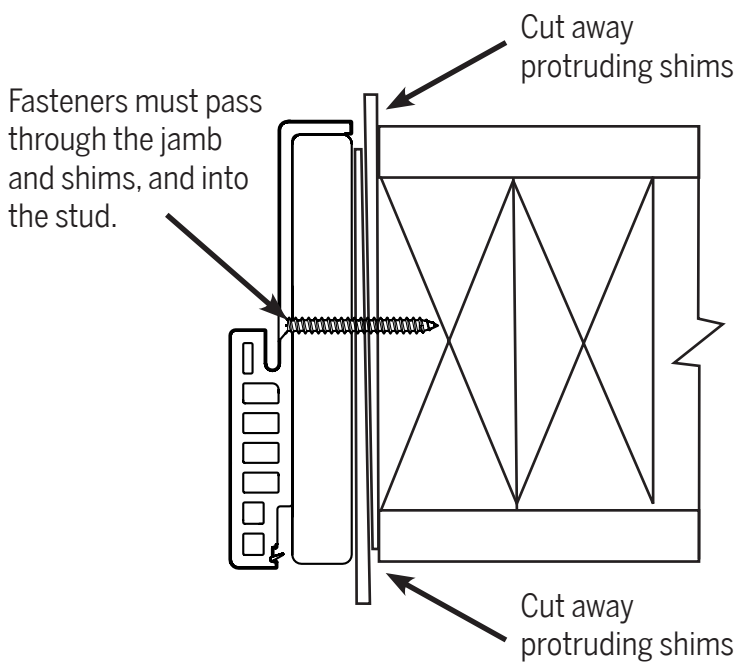

ADDITIONAL NOTES:

- A maximum 1/8" (3.2mm) clearance between the frame and door is allowed.
- A maximum 1/8" (3.2mm) clearance between leaves of pairs is allowed.