

Ultimate Astragal Family

Repainting Instructions

General Notes:

1. This instruction describes suggested preparation steps for painting over Endura's Ultimate Astragal factory applied finish. This instruction applies to all versions of the Ultimate Astragal family, excluding the Ultimate Astragal Veneer.
2. This instruction covers preparation of the extruded aluminum body, but not any of the components assembled to the body. Most astragal components are manufactured from various types of plastics. Painting of these plastic components is not recommended.
3. Numerous types and brands of paint can be used when refinishing Endura's Ultimate Astragal. Application instructions specific to the paint used to refinish the Ultimate Astragal should be properly followed.
4. Endura's factory applied paint is one of the following types:
 - Epoxy powder coat
 - Polyester powder coat
 - Polyester wet spray**(Note – Technical data sheets can be provided upon request.)**
5. It is recommended that only the surfaces noted below be refinished. Paint applied to other surfaces may interfere with proper component fit or function.

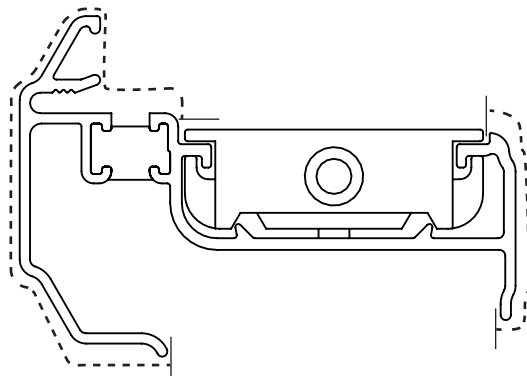

----- Paint Application Surfaces

Disclaimers:

1. Endura cannot guarantee that the long term performance of a repainted top coat will match that of the originally applied factory paint.
 2. These instructions intend to provide the best practices recommended by Endura's paint vendors for application of paint on top of factory applied paint.
- * Trademarks are property of their respective owners.

The information contained in this document is the confidential and proprietary information and trade secrets of Endura Products, Inc. Any disclosure, use or dissemination of such information without the express written permission of Endura Products, Inc. is strictly prohibited. Endura Products, Inc. also owns any and all intellectual property rights embodied in such information, including patent rights, copyrights, and trademark rights, and no license of any intellectual property right is intended, nor should any license be implied, as a result of the receipt of this document.

Rev Date: 9.13.2017



8817 W. Market St., Colfax, NC 27235
1.800.334.2006 www.enduraproducts.com

STEP 1A: INITIAL PREPARATION (UNINSTALLED ASTRAGAL)

Option 1: Remove Astragal Components

- For Multi-Point and Flip Lever Astragals, attach Endura's Paint Shield following separately issued instructions.

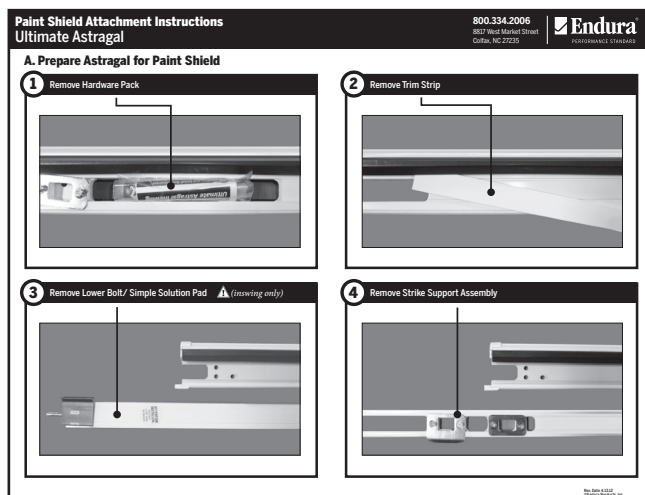

- For all other Ultimate Astragals remove all components from the astragal body, including the weatherstrip.



Option 2: Mask Astragal Components

- Remove weatherstrip, bottom bolt, and strike plates.
- Mask body and components with a painter's tape (such as ScotchBlue™ Painter's Tape or FrogTape® Multi-Surface).



STEP 1B: INITIAL PREPARATION (INSTALLED ASTRAGALS)

All Astragals

- Remove bottom pad (inswing applications only)
- Remove weatherstrip and strike plates.
- Mask components with a painter's tape (such as ScotchBlue™ Painter's Tape or FrogTape® Multi-Surface).
- Mask door faces along edges of astragal.



STEP 2: PREPARE ASTRAGAL BODY



a. Scuff Existing Paint

- Scuff existing painted surfaces intended to be repainted, using a sandpaper pad.
- Ensure that all surfaces are scuffed, including corners.



b. Clean Surfaces

- Wipe all surfaces with a clean, damp rag to ensure they are free from dust, oils and other contaminants.
- Allow surface to dry before applying the refinishing paint.

STEP 3: REPAINT ASTRAGAL

- It is recommended that an exterior grade, solvent based, liquid paint be used. Alkyd, acrylic enamel, epoxy, or urethane types are suggested. Latex type paints are not recommended.
- Apply refinishing paint per the manufacturer's recommended instructions.
- Pay special attention to recommended application temperatures, including the astragal surface temperature, and drying times.

STEP 4: REASSEMBLE ASTRAGAL

- Allow astragal to dry and return astragal components.