

INSTALLATION INSTRUCTIONS



Certified Powered By Endura™ Door Systems

These instructions apply to the following Certified Powered By Endura™ Systems:



Single Doors



Single & Double Continuous Sidelite Units

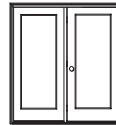

French & Patio Units

Failure to follow all steps of this instruction will void the Certified Powered By Endura™ Warranty.

- Note:** This instruction assumes a typical wood frame wall installation. Adjustments may be required for other wall types.
- Note:** This instruction assumes that an appropriate weather-resistive barrier is applied to the rough opening and integrated with the door unit, as required by local building codes and/or manufacturer's instructions.
- Note:** This instruction applies to both inswing and outswing doors, except where noted.

Installation Tools and Materials

Installation will require the following tools and materials:

- Level - 3' and 6'
- Tape measure
- Masonry string
- Caulking/Sealant- (a) polymer based sealant, such as Bostik Pro-MS 50, (b) polyurethane sealant, or (c) 100% silicone sealant.
- Caulking gun
- Shims (material type compliant with applicable building code requirements)
- #8 x 2-1/2" exterior grade screws (or alternate size compliant with applicable building code requirements)
- 8d finishing nails, exterior grade
- #2 Phillips screwdriver
- Driver with #2 Phillips bit
- Simple Solution Corner™ Pads

Note- Other tools and materials may be required due to rough opening conditions or applicable building code requirements.

General Notes

- Endura recommends that the installer understand the hazards of handling material with lead paint. More information is available at www.epa.gov/lead.
- Construction waste should be disposed of properly.
- Applicable building codes supersede this instruction where differences arise.
- Endura cannot be held liable for defects or deficiencies resulting from improper use of these installation instructions or failure to follow building codes.

1 Preparing the Rough Opening

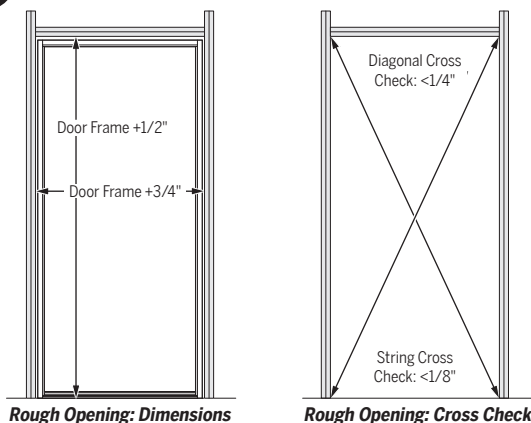

Rough Opening: Dimensions

Rough Opening: Cross Check

Rough Opening Dimensions: Height = Door Frame +1/2"
Width = Door Frame +3/4"

Diagonal Distances should be within 1/4" of each other.

Diagonally placed strings should be within 1/8" of each other at the center.

Ensure support underneath sill front edge overhang. If sill front edge is not properly supported, build out structure to support it.

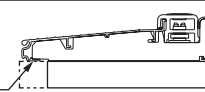

The rough opening should be flashed according to local building code requirements.

- Are the walls straight?
- Is the rough opening framing plumb & level?
- Is the subfloor clean, dry, level and solid?

If you are using a height plate to bring the sill up to the level of the finished floor covering:

Be sure that it is at least as wide as the sill and as long as the rough opening.

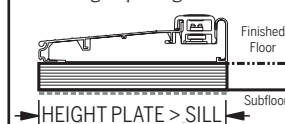

Be sure to caulk thoroughly under and around the height plate.

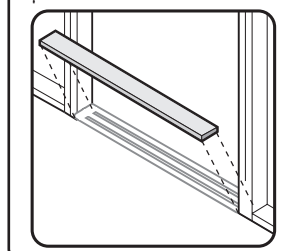

Check both sides

2 Caulking the Rough Opening

NOTE: Where caulking is required a polyurethane, 100% silicone, or polymer-based exterior grade sealant may be used.

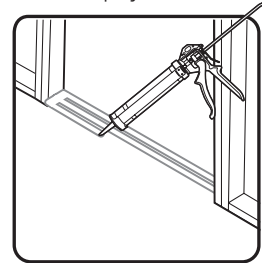

Place three heavy beads (1/2" wide) of sealant on the subfloor or height plate as shown.

Put enough caulk at the ends to completely cover the bottom of the side jamb.

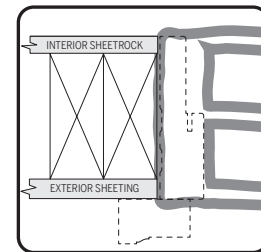

Apply a continuous 1/2" bead sealant to sheathing side of brickmould or exterior trim (ensure that sealant is compatible with sheathing, housewarp or flashing at rough opening).

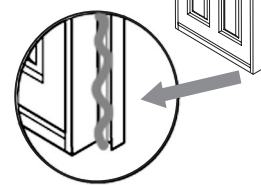

2a Optional Sill Pan

An Endura approved Sill Pan may be used in Certified Powered By Endura™ Systems, but is not required.

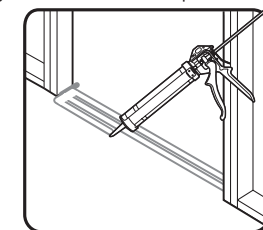

1. Place three heavy beads (1/2" wide) of sealant on the subfloor or height plate as shown.

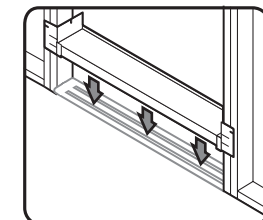

2. Place and secure Endura approved Sill Pan according to separately issued Endura Instructions.

3. Seal Interior Edges

Perform after door unit is anchored into rough opening.

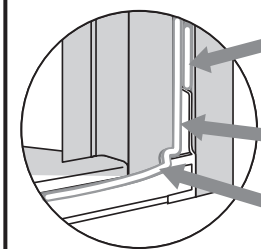

Apply sealant between the rough opening and the jamb, 6" above the end caps.
NOTE: Backer rod may be needed.

Apply sealant between the back edge of the end cap and the jamb.

Apply sealant between the back edge of the sill pan and the sill.

3 Position Unit in Rough Opening

Pivot into position taking care not to wipe away subfloor caulking.

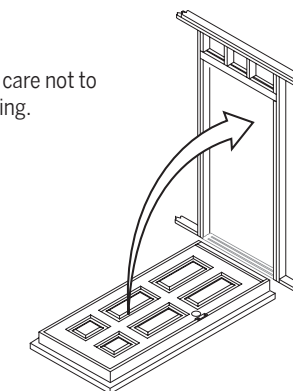

Temporarily secure using finishing nails through the brickmould. Do not fully set nails.

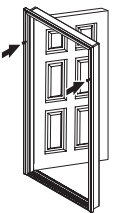

Ensure that unit is plumb in each direction.

Ensure that inside edge of door unit projects 1/2" past stud interior surface for proper alignment with drywall.

Place fasteners through thick part of jambs as shown, just above the hinge positions on the hingejamb. Do not fully seat. Use 3 screws for 7/0 and shorter units, & 4 screws for 7/5 and taller units.

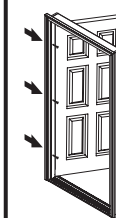

Single Units:
Fasten Hinge Jamb First

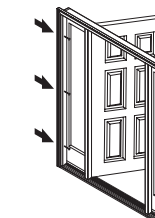

Sidelite Units:
Fasten Sidelite Jamb on Hinge Side first.

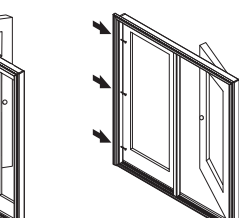

French & Patio Units:
Fasten Jamb on fixed or passive side panel first.

For systems with brickmould or other exterior trim, assure that backside of moulding is up against exterior sheathing.

Note: Do not secure door unit only through brickmould or other exterior trim.

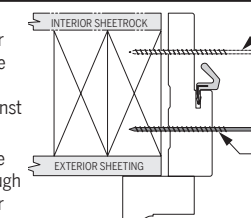

Alternate screw location - do not damage weatherstrip.

Use #8 x 2-1/2" wood screw or equivalent fastener. Do not fully seat.

Note: Door units installed in high velocity wind zones will require anchoring according to approved requirements.

4 Shim and Secure Hinge Jamb

Temporarily install Simple Solution™ Pads, but do not remove adhesive backing paper yet (see Step 8 for pad positioning).

Check hinge jamb for plumb in both directions with a 6-foot level.

Place shims behind jamb hinges. Adjust shims to take up space between jamb and rough opening.

Note: In some cases, the rough opening is plumb and allows the door jamb to be placed against the rough opening. Shims on this side will not be required.

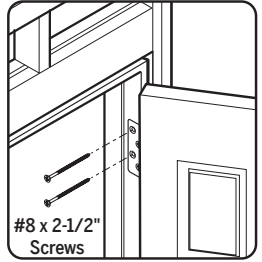
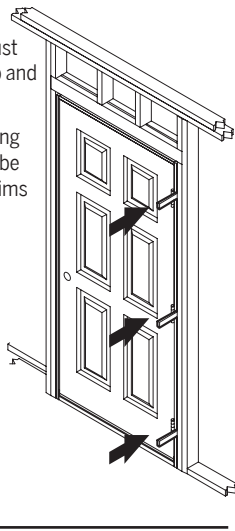

On top hinge, replace 2 short screws closest to weatherstrip with #8 x 2-1/2" screws.

On all other hinges, replace top screw closest to weatherstrip.

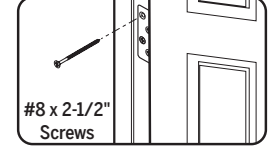

Set each jamb screw through shims, then remove excess shim.

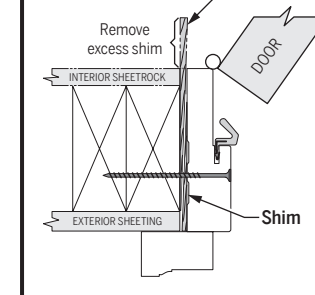

Note: Make sure the jamb is not bowed. Adjust or apply additional shims as necessary.

5 Shim and Secure Opposite Jamb

Check jamb for plumb in both directions with a six foot or longer level.

Install shims across from each hinge and adjust to ensure a 1/8" consistent margin between panel and jamb.

Adjust the frame so it is flush with the face of the door.

Check the weatherstrip contact for even compression all around the door.

Set each jamb fastener through shims.

Remove excess shims when done.

Note: Make sure the jamb is not bowed. Adjust or apply additional shims as necessary.

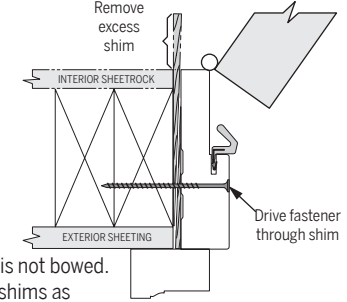
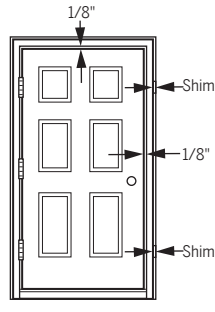

10 Astragal Positioning (French Units only)

Close the passive door to verify that it is in the desired position.

Push bolt pins to contact header and sill, then mark positions for retainer holes.
*** For Z-Articulating Cap, only the header mark is required.**

Complete installation and positioning of astragal according to Endura's "Field Installation Instructions" provided with the French Door Unit.

The strikes should be adjusted in the direction of door closure to assure that the strikes pull the door up to the weatherstrip tightly.

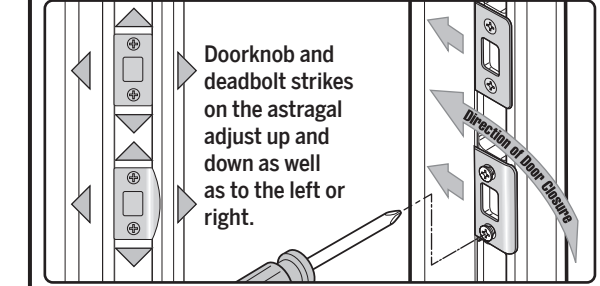

6 Securing Lockset Hardware

Install lockset hardware

With door closed, shim behind strike and deadbolt plates to maintain proper margin.

Secure each plate with two #8 x 2-1/2" screws through the shim and into the rough stud. Remove excess shim.

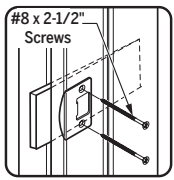

7 Shim and Secure Header

Secure fasteners through thick part of header. Use shims at each location indicated by (X) to maintain proper margin.

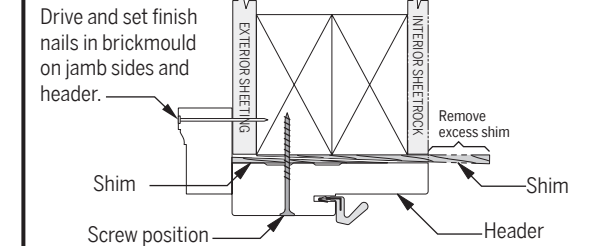
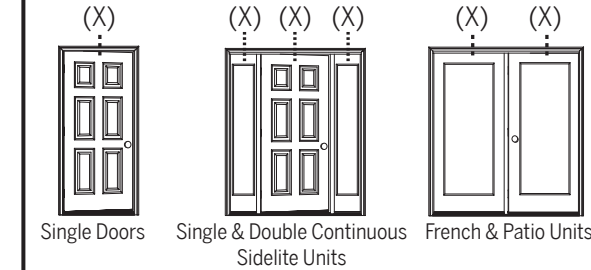

11 Weatherproofing

Caulk around the entire unit on weather-exposed side between brickmould and siding or sheathing.

Caulk at joint of brickmould and jamb/header

Self-adhering flashing installed per the manufacturer's instructions may be used in a place of caulking, as long as the entire interface between the brickmould and frame and brickmould and siding is water tight.

Install flashing above protruding header trim in shingle lap fashion, or per manufacturers instructions, or according to applicable building code requirements.

Insulate the gap between the frame and rough opening according to applicable building code requirements.

Additional or alternate flashing methods may be required according to applicable building code requirements.

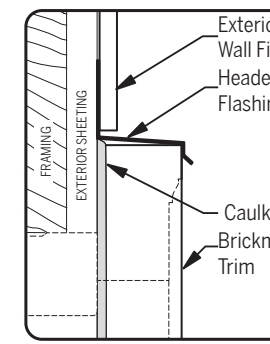
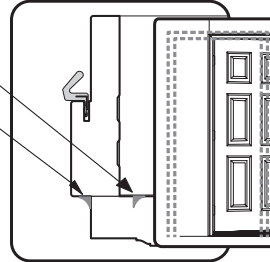

8 Remove End Base Protective Label

Z-Articulating Cap Sills™ Only
Depress the Z-AC, to gain access to the orange protective labels on each Z-End base.

Grasp the inside tab of the orange protective label on the Z-End Base™ / Mull Stiffener, shown here and lift up and away from the Z-End Base.

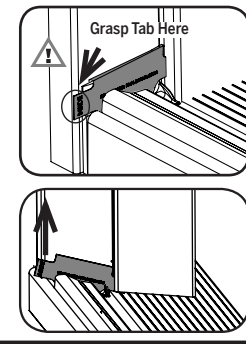

9 Adjust Sill

Remove temporarily installed Simple Solution™ Corner Pads

If necessary, adjust the sill cap to ensure consistent spacing between panel and cap.

***Does not apply to Z-Articulating Cap**

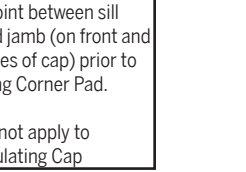
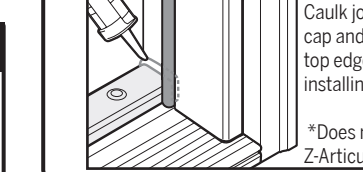
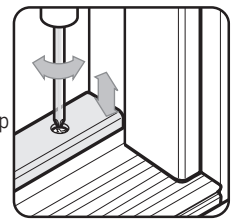
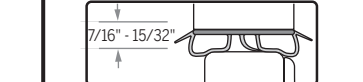

10 Check Corner Pads

Verify proper installation of Simple Solution Corner Pads

To install Simple Solution Corner Pads, remove paper backing to expose adhesive, and press firmly into place. For margins less or equal to than 5/32", apply the corner pad with the edge flush against the weatherstrip kerf, and for margins greater than 5/32", apply the corner pad with the edge flush against the interior jamb. Pads not required on outswing jambs.

⚠ Strike Margins greater than 5/32"

⚠ For Strike Margins less than 5/32"

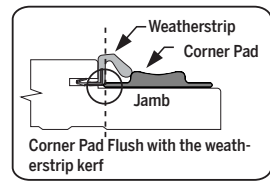
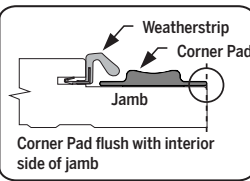
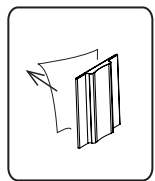

For Adjustable Sills/ Oak Anchored Caps
The Simple Solution Corner Pad must contact the top of the sill cap.

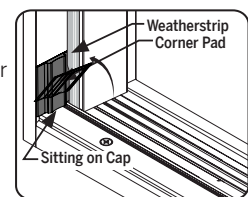

For Z-Articulating Caps
The Simple Solution Corner Pad must contact the top surface for the Z-End Base™.

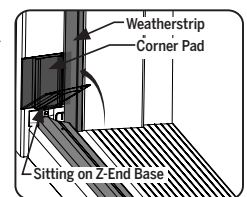

www.enduraproducts.com

Certified Powered By Endura™ and Simple Solution™ Corner Pad are trademarks of Endura Products, Inc. All rights reserved.