

Ultimate Lite Astragal

Inswing Field Installation Instructions



8817 West Market Street
Colfax, NC 27235 | 800.334.2006
www.enduraproducts.com

Tools Required:

- Pencil/Marker
- Utility Knife
- Flathead Screwdriver
- Drill (3/8" and 5/8" Bits)
- Rubber Mallet

Kit Includes:

- Lower Bolt Receiver
- Header Strike Plate
- (2) #6 x 1-1/2" Screws

Before you begin: Install corner pads on door hinge jambs to establish proper jamb side margins. This ensures accurate locations on header and sill for the bolt receivers.

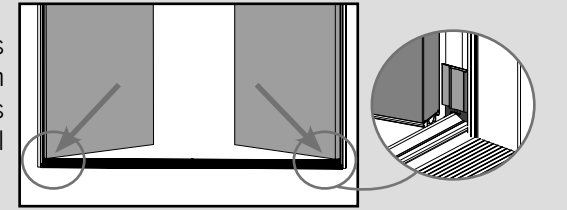

STEP 1: INSTALL HEADER AND SILL BOLT RECEIVERS

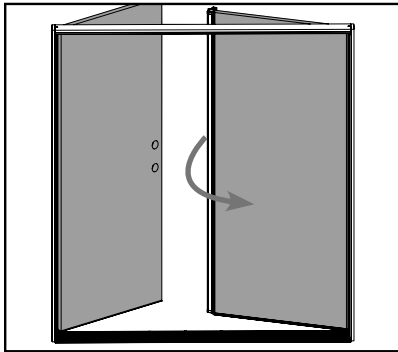

a. Close the inactive door panel until the weatherstrip on the header is compressed.

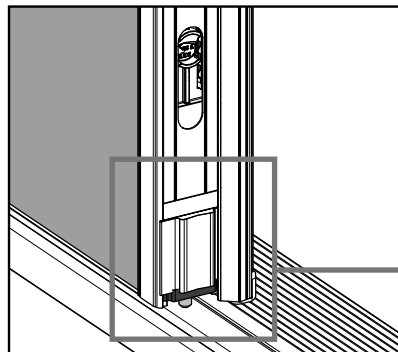

b. Press and engage the upper and lower bolts so the bolt pins come in contact with the header and the sill. Mark these points of contact.

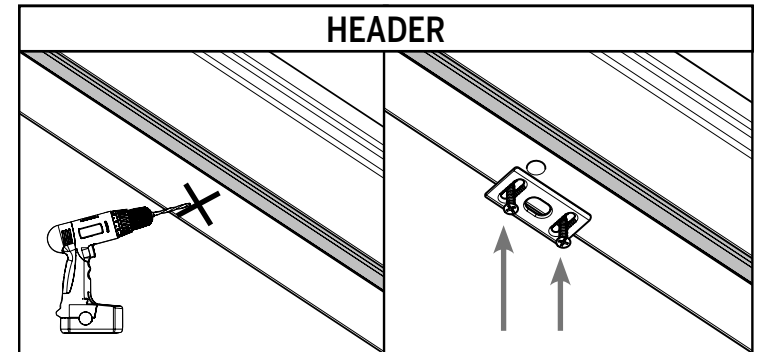
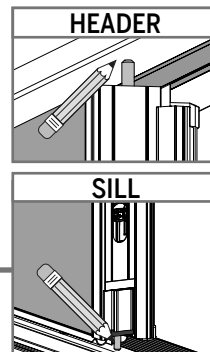

c. At the marked location on the header, drill a hole **3/8" in diameter** and at least **1-3/8" deep**. Install the header strike plate into the header, using two #6 x 1-1/2" screws.

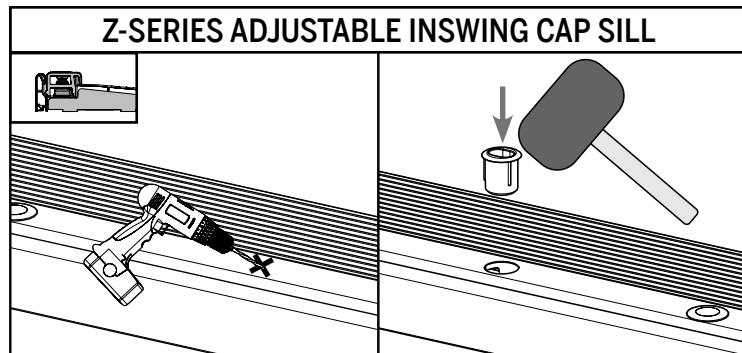

d. At the marked location on the sill, drill a hole **5/8" in diameter** and at least **1-3/8" deep**. Install the lower bolt receiver by tapping into the sill with a rubber mallet.

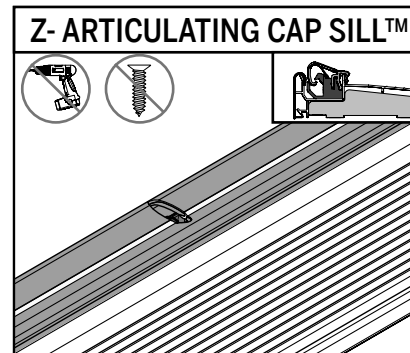

NOTE: If using a Z-AC sill, **no drilling is necessary** as the bolt receiver is pre-installed.

Rev. Date: 6.12.2018
©Endura Products, Inc.
Innovation protected under patents and patents pending
in U.S. and Canada. See www.EnduraPatents.com
#211159-LITE-I-FP

STEP 2: INSTALL STRIKE AND DEADBOLT PLATES

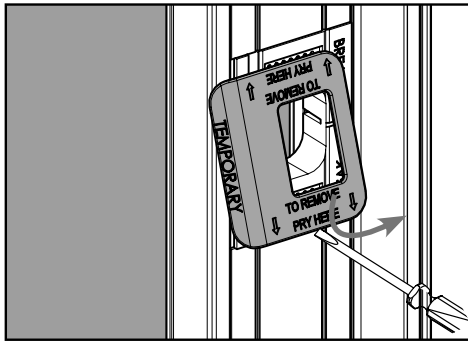

a. When you are ready to install the hardware on the door, pry off the dummy strike plates using a flathead screwdriver.

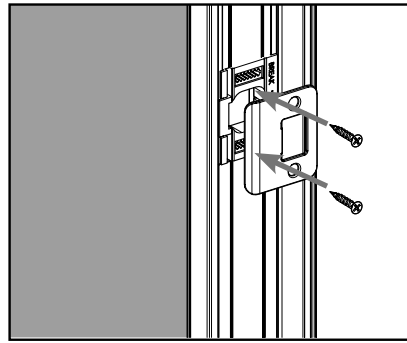

b. Install the strike and deadbolt plates by screwing into the retainers.

If the hardware has mounting holes greater than 1-5/8" center to center:

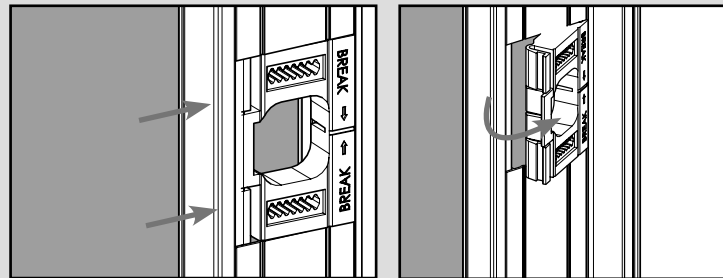
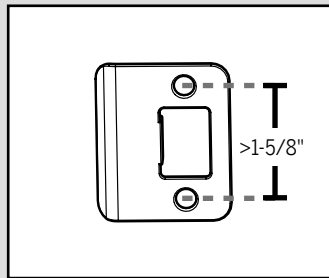

a. Remove the retainers from the astragal body by pushing the tabs in and rotating the retainer out.

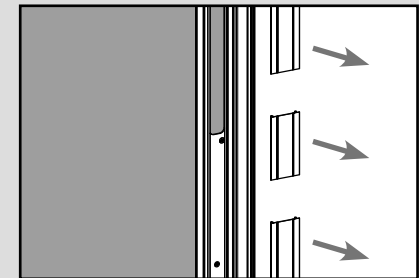

b. Remove the trim strip from the astragal and set aside.

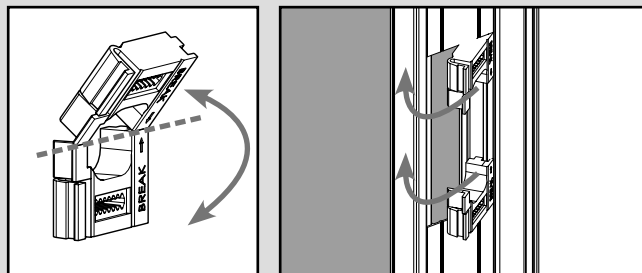

c. Break retainer in half using the bend lines. Return the two pieces of the retainer to the astragal and adjust to fit the larger hardware.

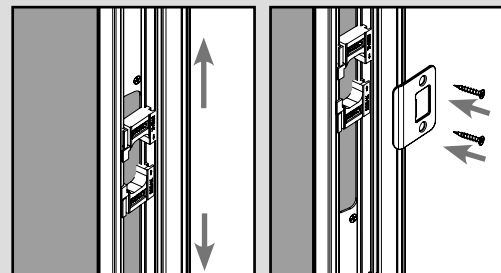

d. Adjust the location of the two pieces of the retainer and install the new hardware.



e. Resize the trim strip to fit flush against the deadbolt and strike plates and install into the astragal.

STEP 3: CUT WEATHERSTRIP AT HEADER

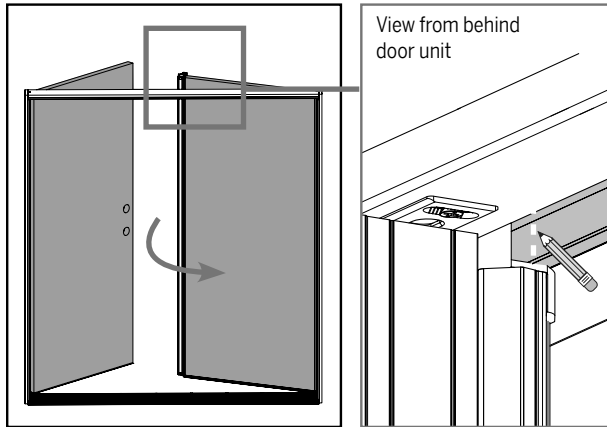

a. Close the inactive door. Make a mark at the location where the trim cap contacts the weatherstrip.

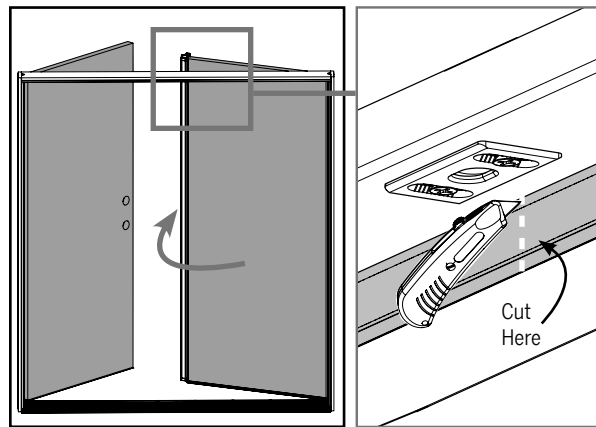

b. Open the inactive door. Using a utility knife, make a slit in the weatherstrip along the mark made.

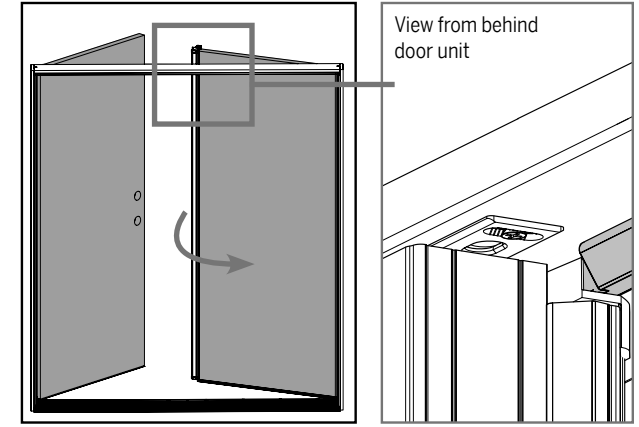

c. Close the active door panel and ensure the weatherstrip forms a secure seal around the trim cap.

STEP 4: CONFIRM PROPER INSTALLATION

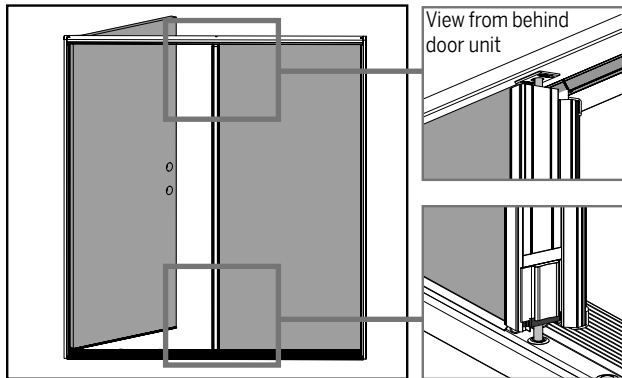

a. With the inactive door closed, engage both the upper and lower bolts to ensure they fit into the bolt receivers smoothly.

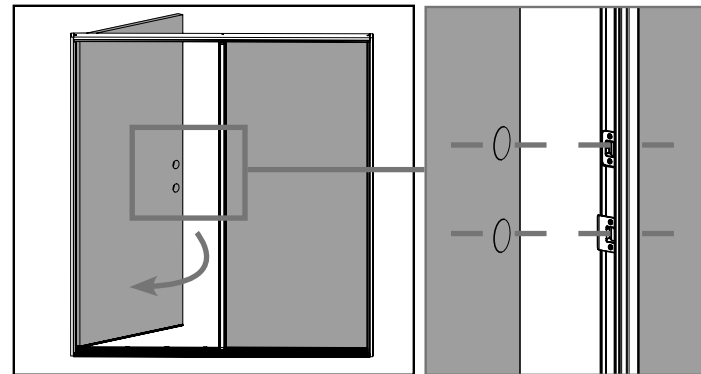

b. Close the active door panel and ensure the deadbolt and strike plates are aligned with the crossbore holes in the active door panel.

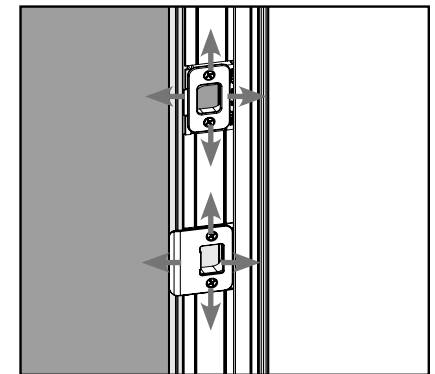

c. If the plates are not aligned correctly, loosen screws and slightly adjust the locations of the plates.