

# Ultimate Trilennium® Astragal Lower Flush Bolt

## Replacement Instructions

### Tools Required:



Phillips  
Screwdriver

### Recommended Parts for Lower Flush Bolts:



Endura Simple Solution  
Corner Pad

### Product Reference Guide

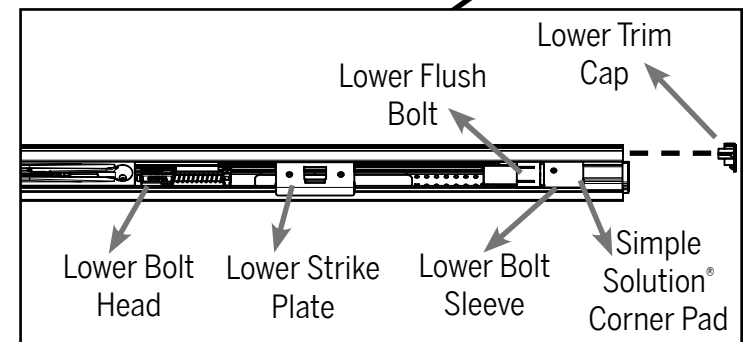
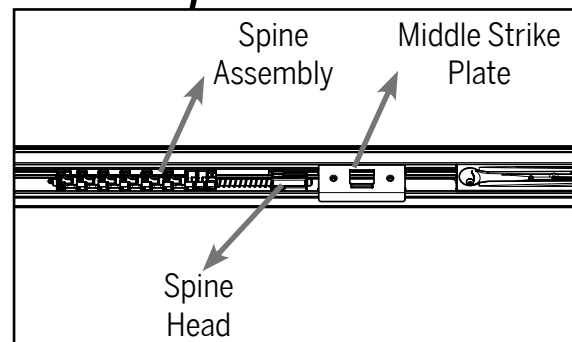
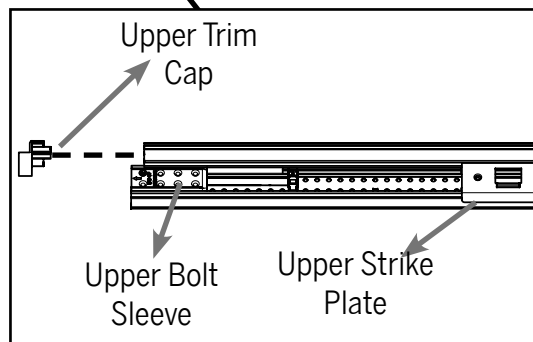
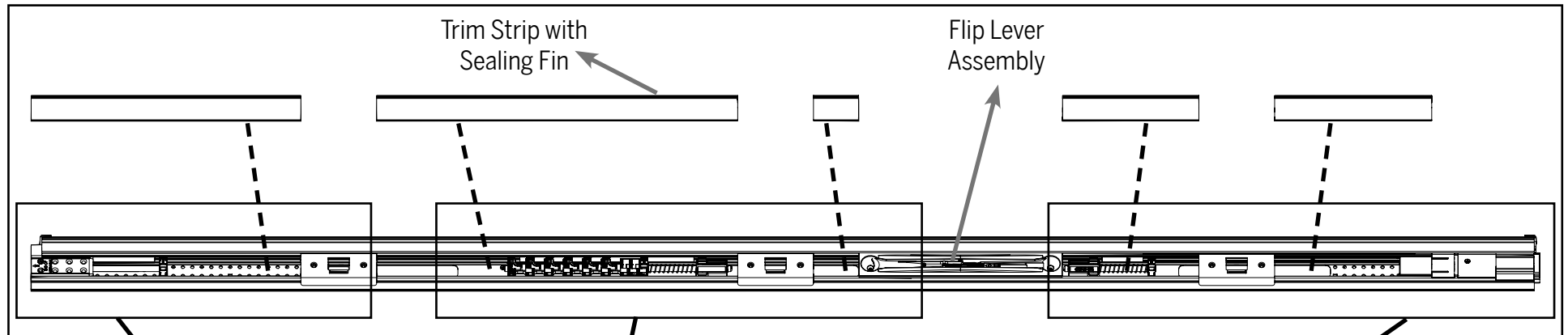

8817 West Market Street, Colfax, NC 27235  
800.334.2006 Fax: 336.668.4478  
www.enduraproducts.com

Rev. Date: 10.24.2017  
©2017 Endura Products, Inc.  
Innovation protected under patents and patents pending in U.S. and Canada. See www.EnduraPatents.com.  
#BD-INST-TC-LOWBOLT

## STEP 1: REMOVE THE INACTIVE DOOR PANEL FROM THE JAMB

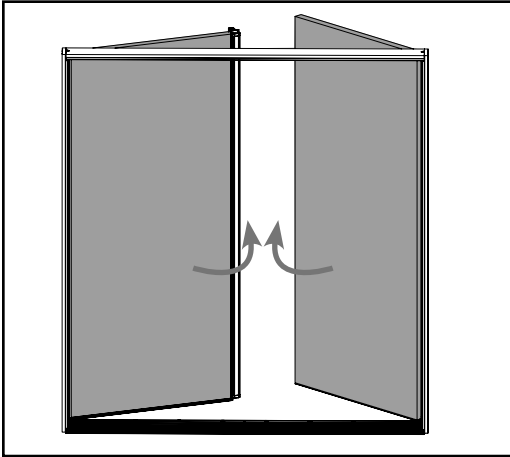

a. Open both door panels to access the hinges of the inactive door panel.

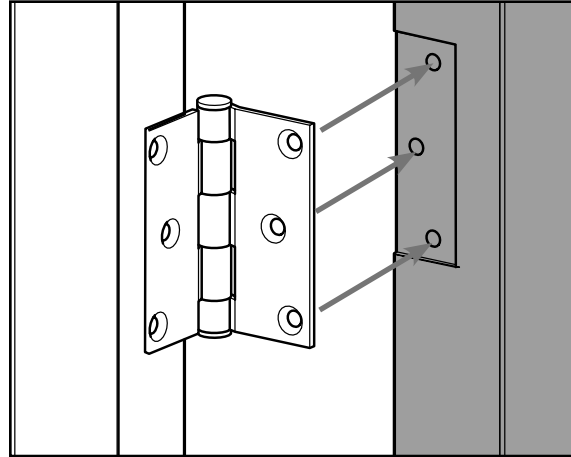

b. Remove screws and detach the inactive door panel from the hinges.

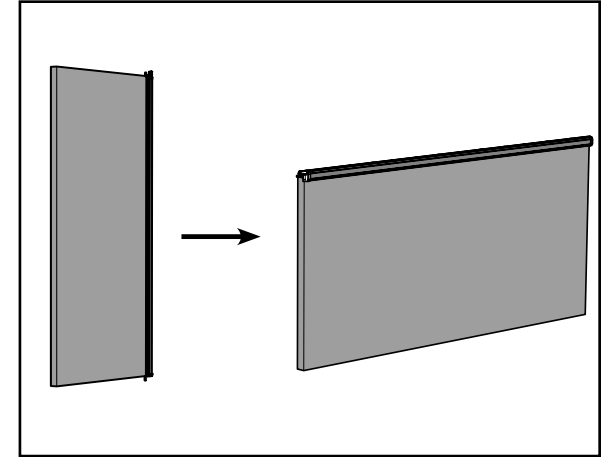

c. Place the door panel horizontally against a strong support to access the astragal.

## STEP 2: REMOVE THE OLD BOLT FROM THE ASTRAGAL BODY

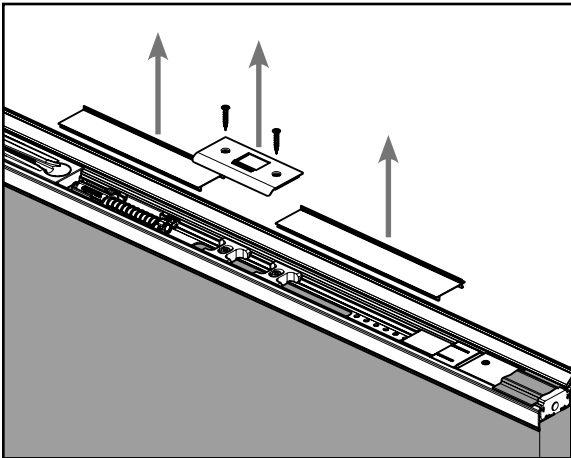

a. Remove the bottom two pieces of trim strip and the lower strike plate assembly. Set aside.

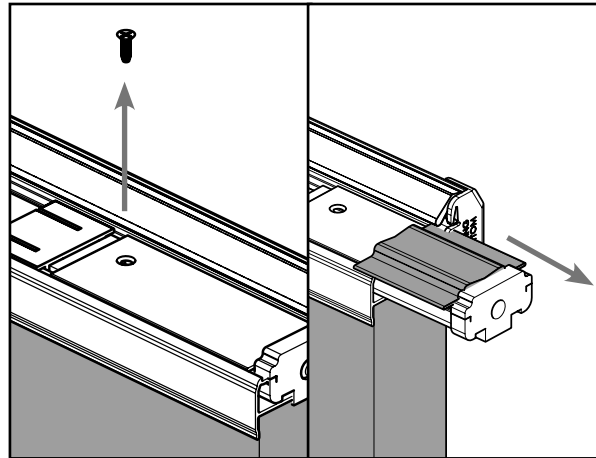

b. Remove the screw securing the lower bolt sleeve. Slide the bolt sleeve out of the astragal body.

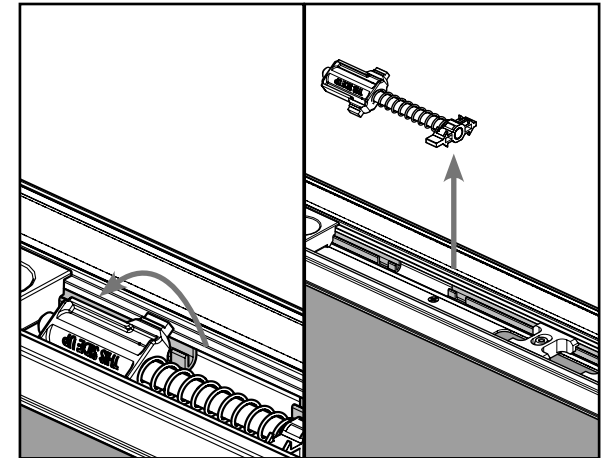

c. Rotate the lower bolt head out of the drive rods and remove that assembly from the astragal body.

## STEP 2 (CONT.): REMOVE THE OLD BOLT FROM THE ASTRAGAL BODY

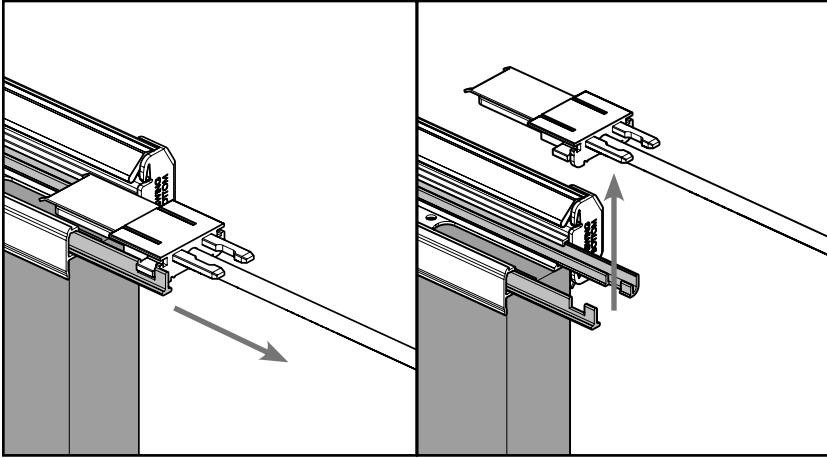

d. Slide out the lower metal drive rods and remove the shoot bolt.

## STEP 3: INSTALL NEW BOLT

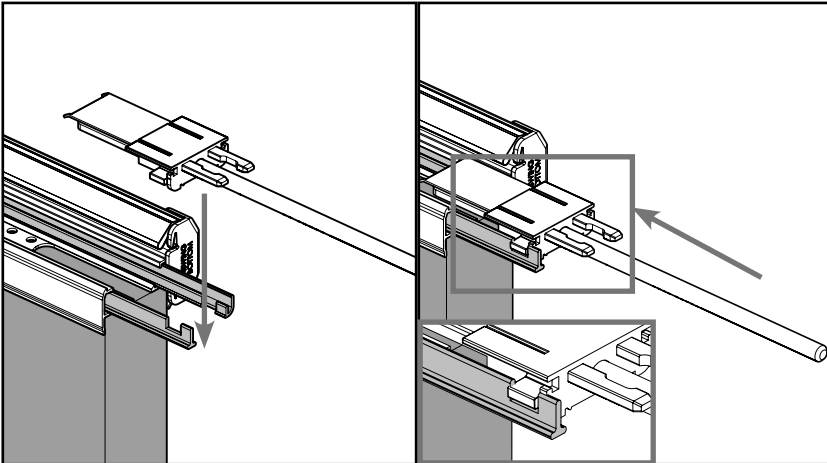

a. Return the shoot bolt so its engagement head notches securely into the grooves on the metal drive rods. Slide the rods back in place.

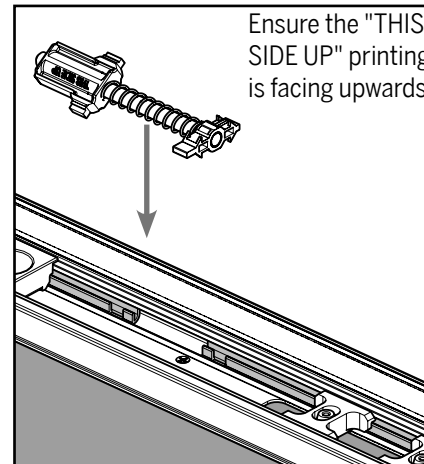

b. Reinstall the lower bolt head back into the drive rods.

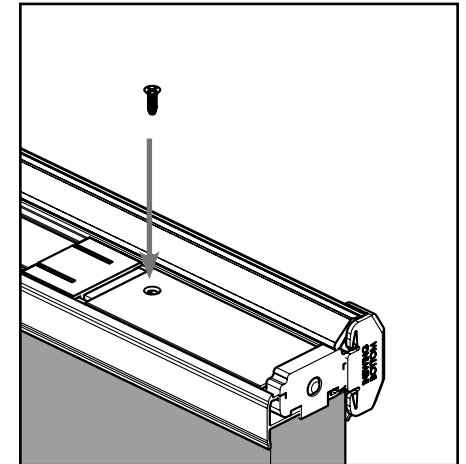

c. Slide the bolt sleeve onto the bolt and secure by reinstalling the screw.

### STEP 3 (CONT.): INSTALL NEW BOLT

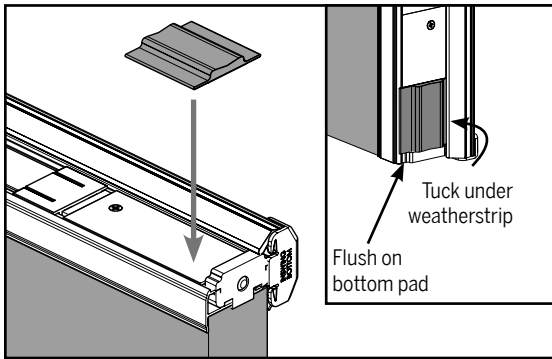

d. Install a new corner pad (purchased separately). Corner pads should be installed flush against the bottom pad and tucked under the weatherstrip.

### STEP 4: CONFIRM BOLT OPERATION

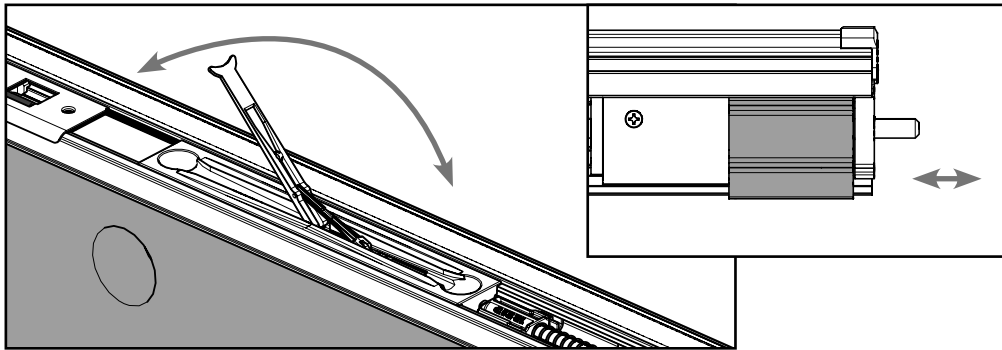

a. Operate the flip lever and ensure the bolt sleeve and pins move between engaged and disengaged positions.

**NOTE:** If the lower bolt does not freely move, the lever may need to be cycled several times.

### STEP 5: REINSTALL THE DOOR PANEL

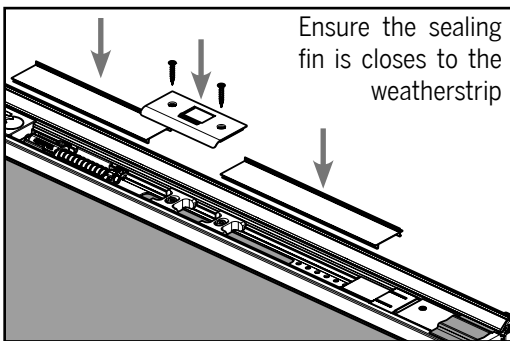

a. Reinstall the lower strike plate assembly and trim strips previously removed from the astragal body.

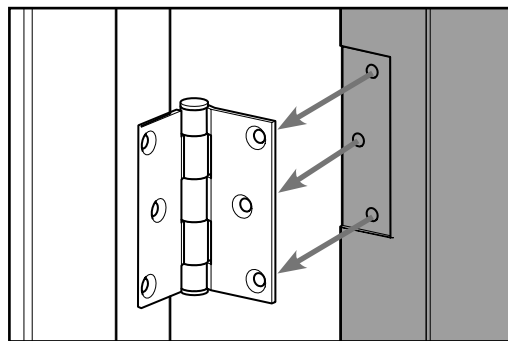

b. Reinstall the inactive door panel by screwing the door panel back to the hinges.

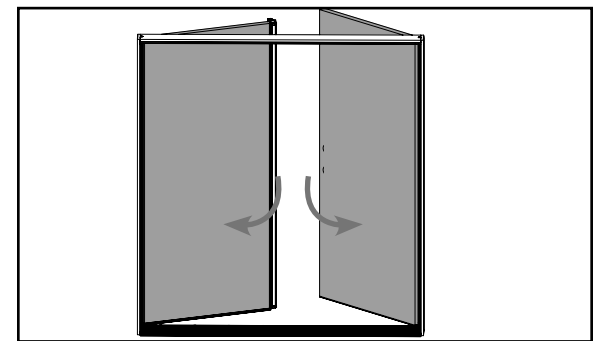

c. Close the inactive door and lock the bolts to confirm proper operation.