

Ultimate Hurricane Astragal Strike Support

Replacement Instructions



8817 West Market Street
 Colfax, NC 27235 | 800.334.2006
 www.enduraproducts.com

Tools Required:



Phillips
Screwdriver

Product Reference Guide

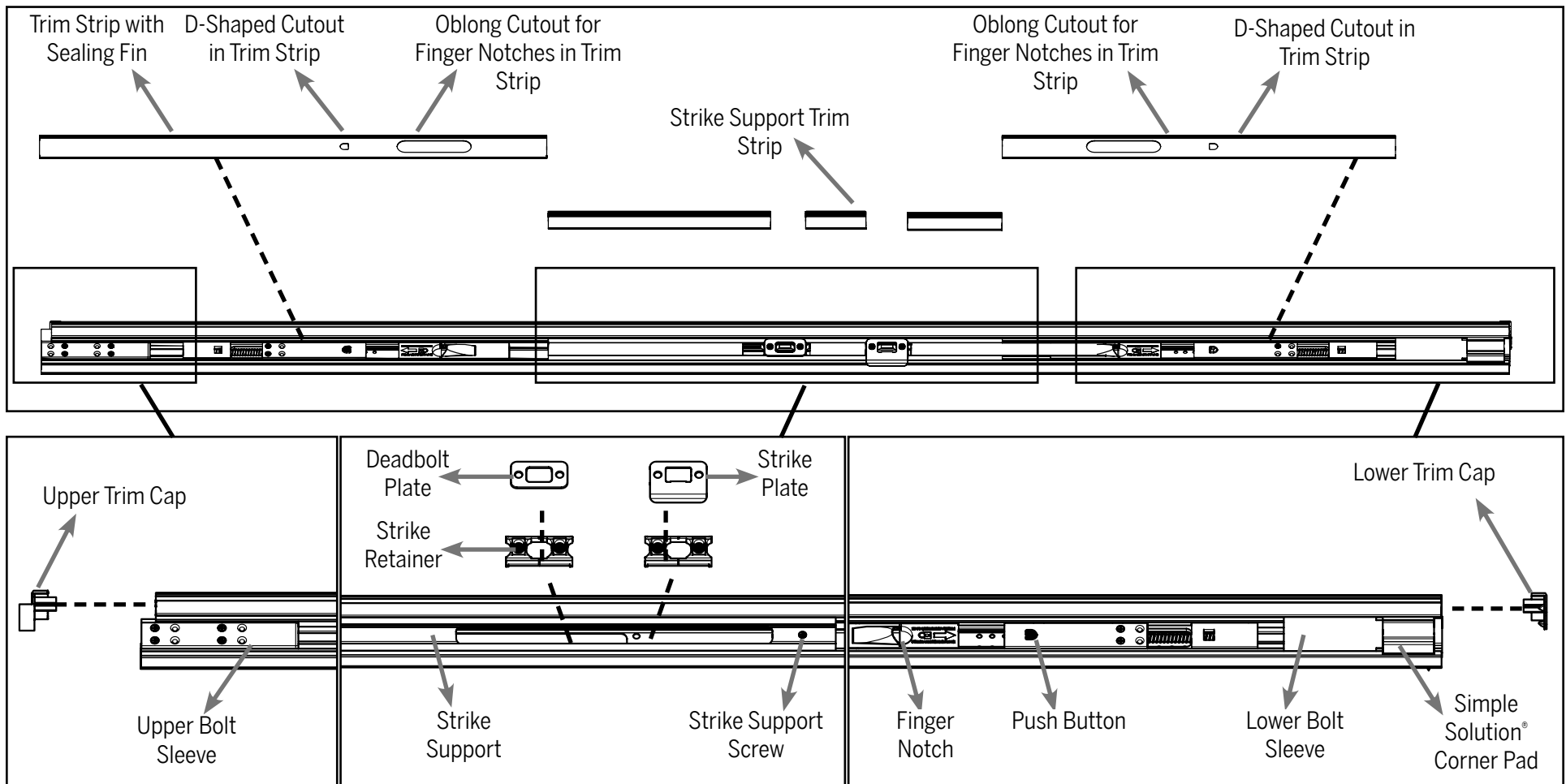

STEP 1: REMOVE THE INACTIVE DOOR PANEL FROM THE JAMB

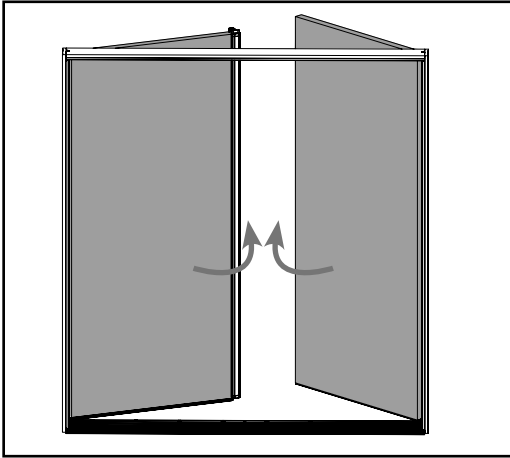

a. Open both door panels to access the hinges of the inactive door panel.

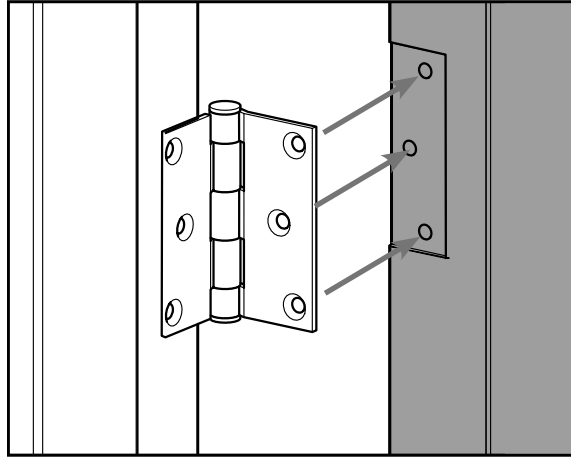

b. Remove the screws and detach the inactive door panel from the hinges.

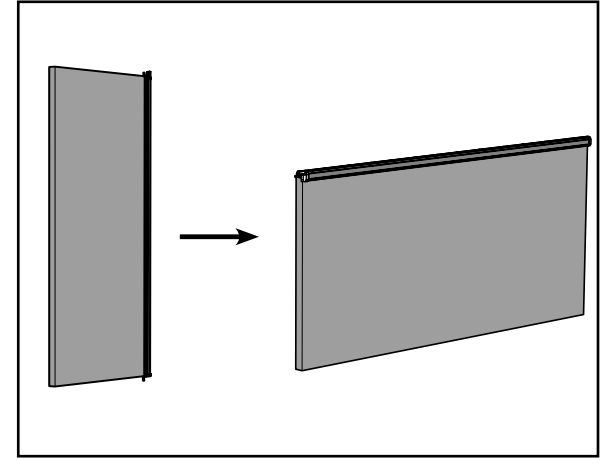

c. Place the door panel horizontally against a strong support to access the astragal.

STEP 2: REMOVE THE UPPER BOLT FROM THE ASTRAGAL BODY

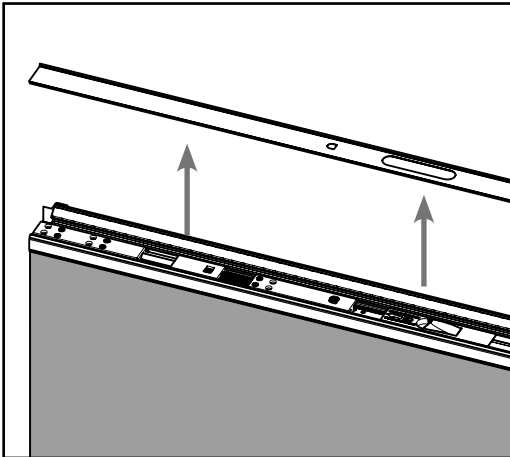

a. Remove the trim strip covering the upper bolt.

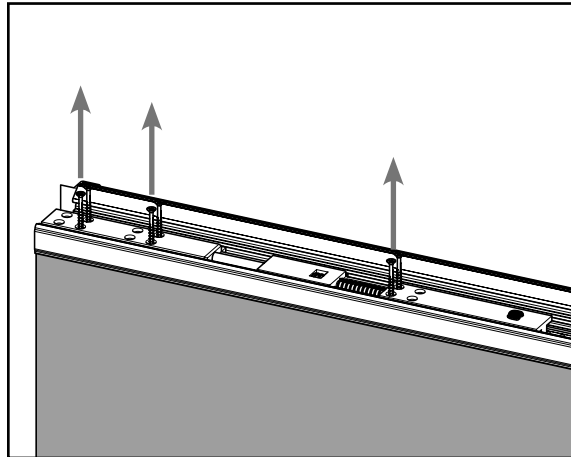

b. Remove the screws securing the bolt into the astragal body and door panel and set aside.

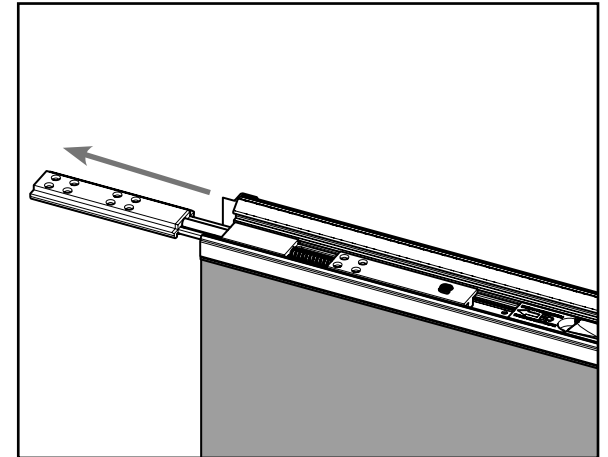

c. Slide the bolt out of the astragal.

STEP 3: REMOVE THE OLD STRIKE SUPPORT

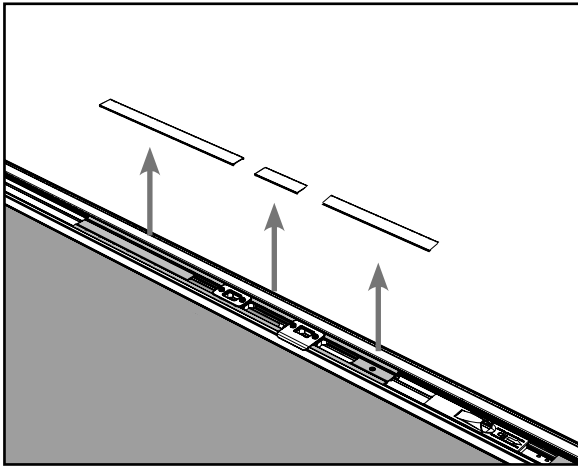

a. Remove the trim strip that's over the strike support and set aside.

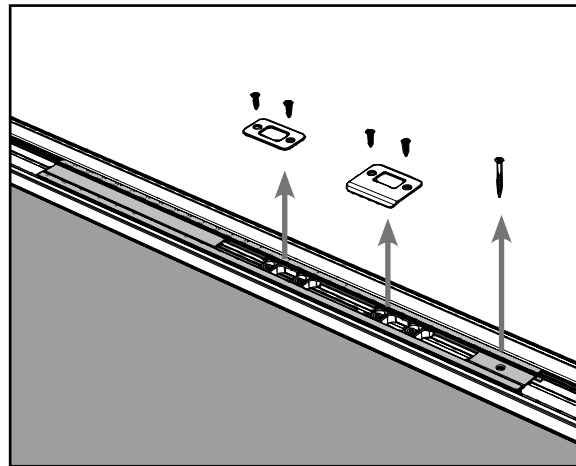

b. Remove the strike support screw and the strike and deadbolt plates. Set aside.

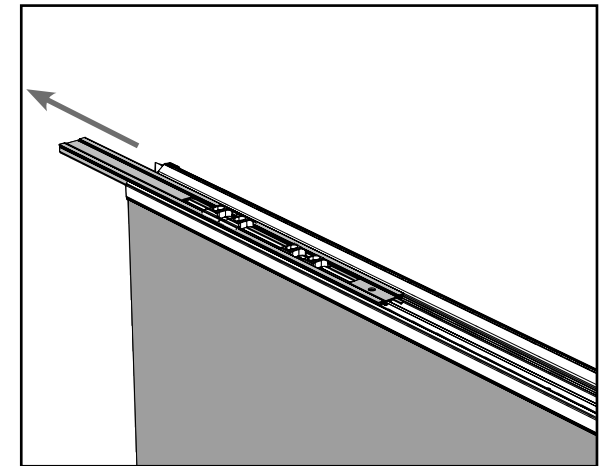

c. Slide the strike support out of the astragal body and discard.

STEP 4: INSERT NEW STRIKE SUPPORT

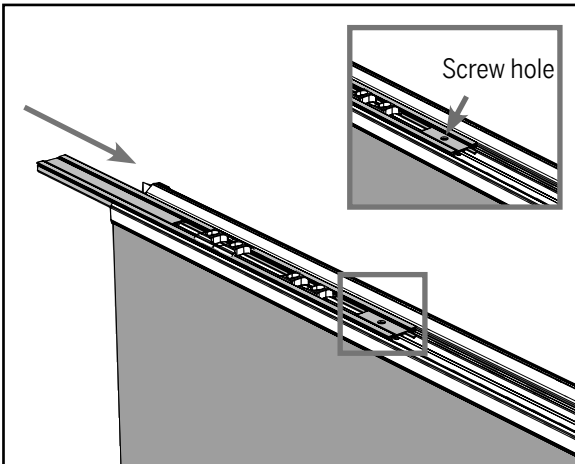

a. With the screw hole towards the bottom of the astragal, slide the new strike support back to the same location of the one you removed and screw into place.

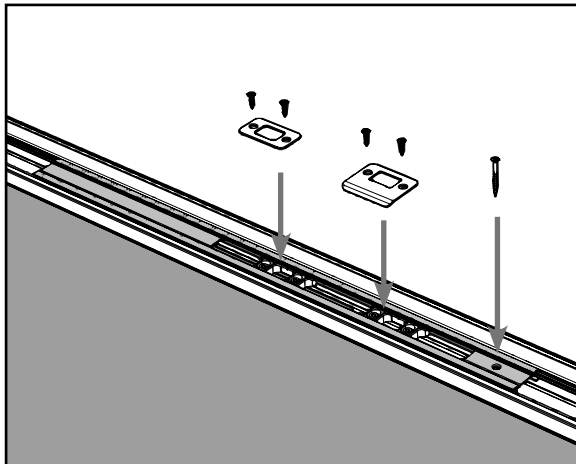

b. Reinsert the screw through the strike support and into the astragal and door panel. Reinstall the strike plate and the deadbolt plate.

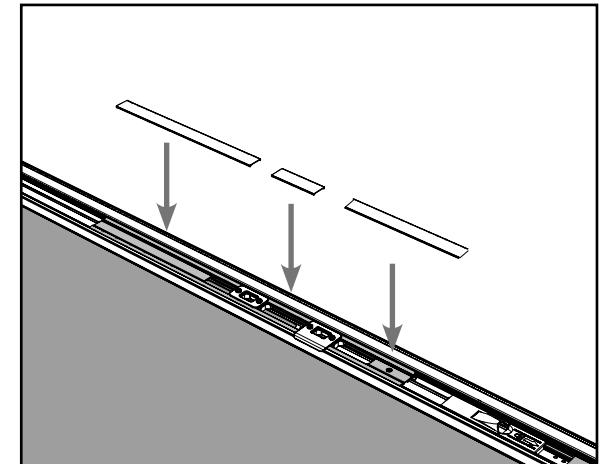

c. Remove the trim strip that's over the strike support and set aside.

STEP 5: RETURN UPPER BOLT

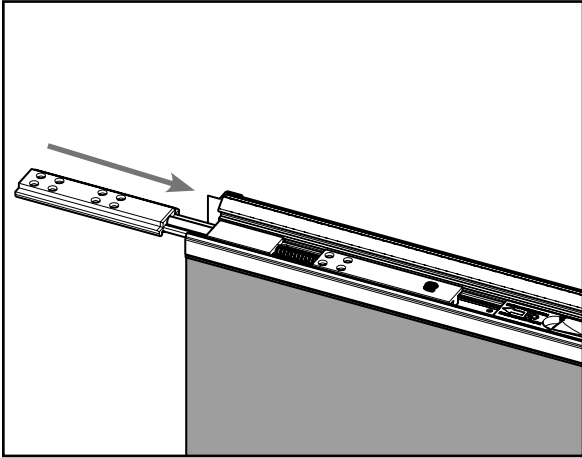

a. Slide the upper bolt back into the astragal body.

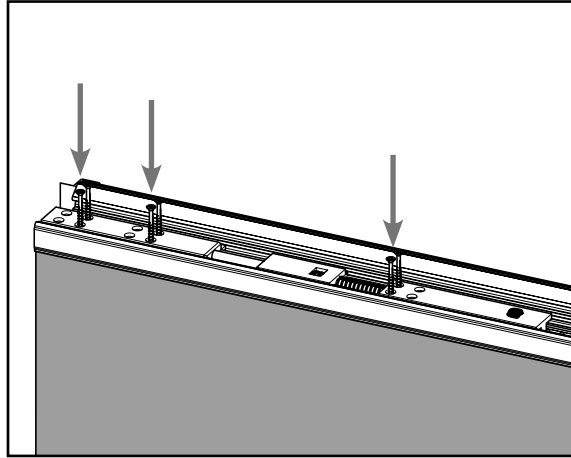

b. Return the screws securing the bolt into the astragal body and door panel.

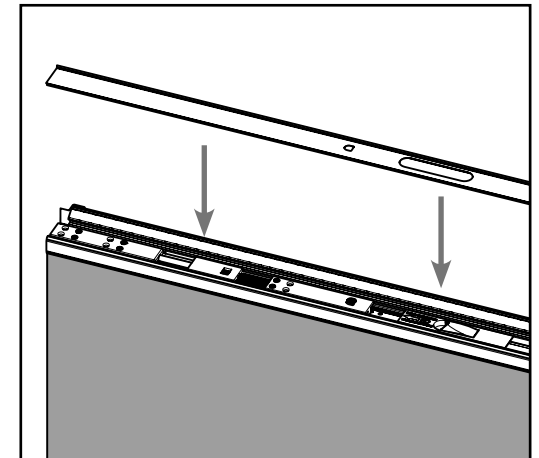

c. Return the trim strip covering the bolt ensuring the sealing fin is on the side closest to the weatherstrip.

STEP 6: REINSTALL THE DOOR PANEL

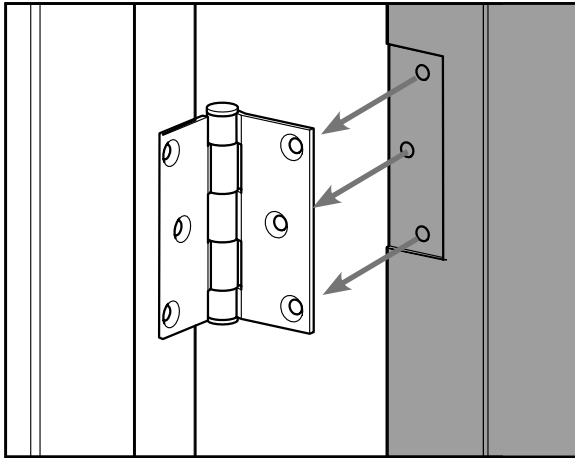

a. Remove the screws securing the inactive door to the hinges.

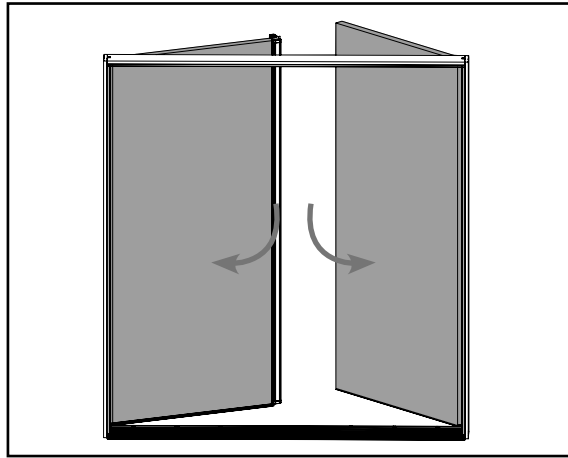

b. Close the inactive door and lock the bolts to ensure the bolts contact the header and sill receivers properly.