

Ultimate Flip Lever™ Astragal Upper Flush Bolt

Replacement Instructions

Tools Required:



Phillips
Screwdriver

Product Reference Guide - Ultimate Flip Lever Astragal

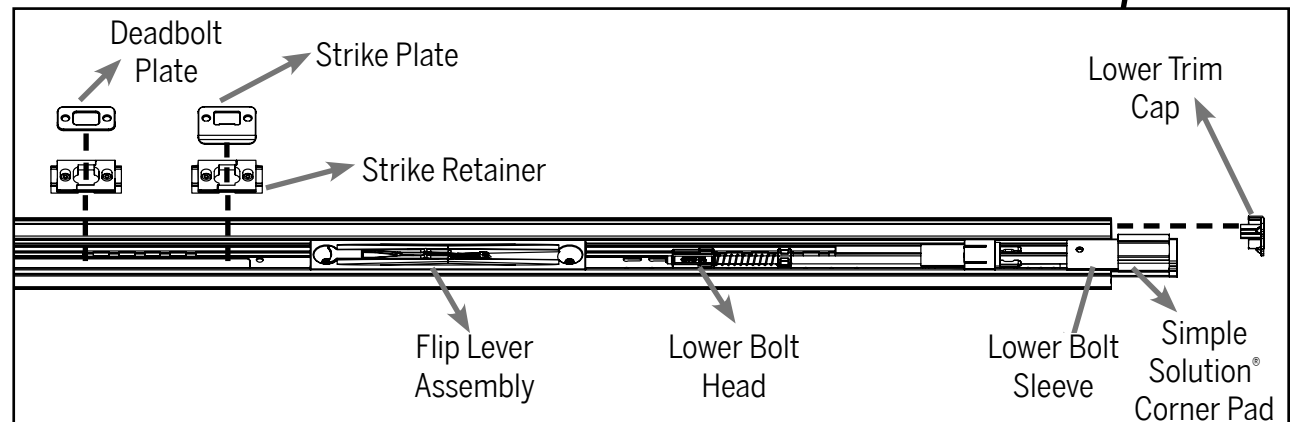
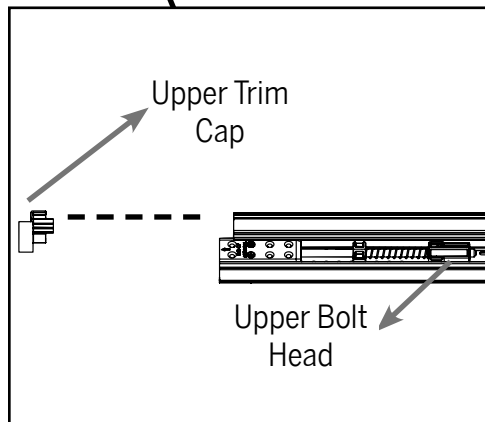
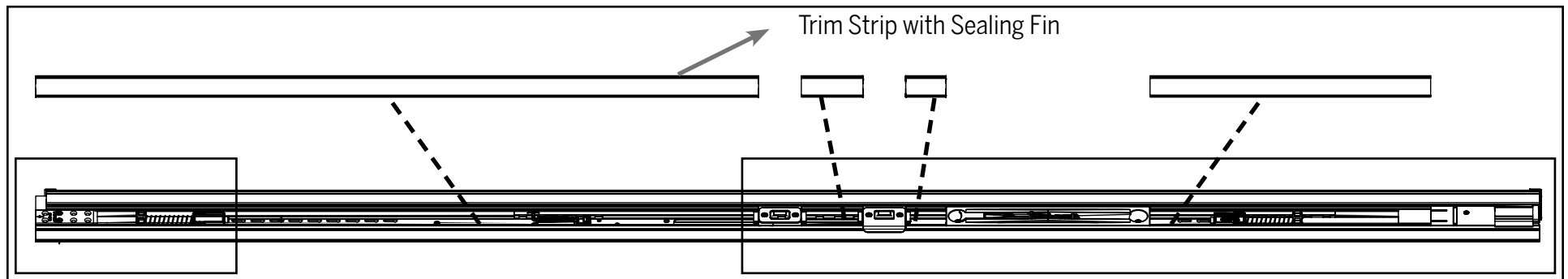

STEP 1: REMOVE THE INACTIVE DOOR PANEL FROM THE JAMB

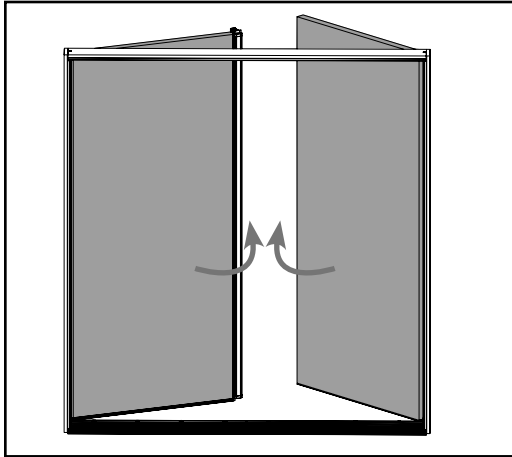

a. Open both door panels to access the hinges of the inactive door panel.

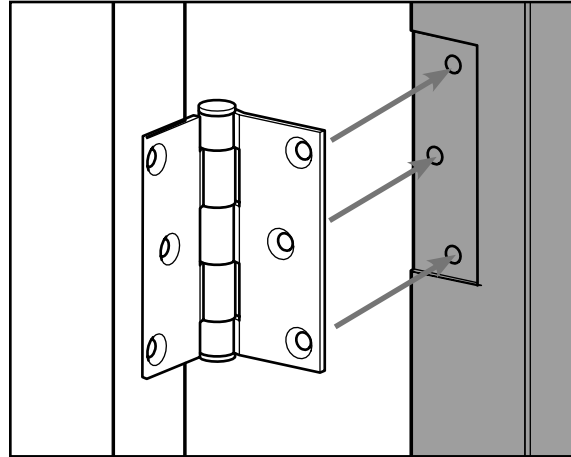

b. Remove the screws securing the inactive door to the hinges.

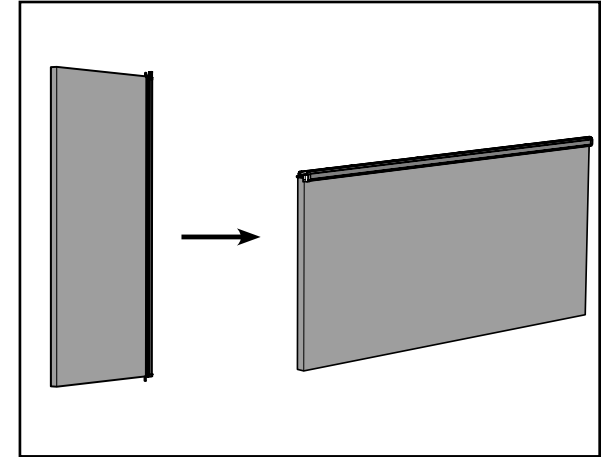

c. Place the door panel horizontally against a strong support to access the astragal.

STEP 2: REMOVE THE OLD BOLT FROM THE ASTRAGAL BODY

Ensure the upper bolt is in the unlocked position before removing.

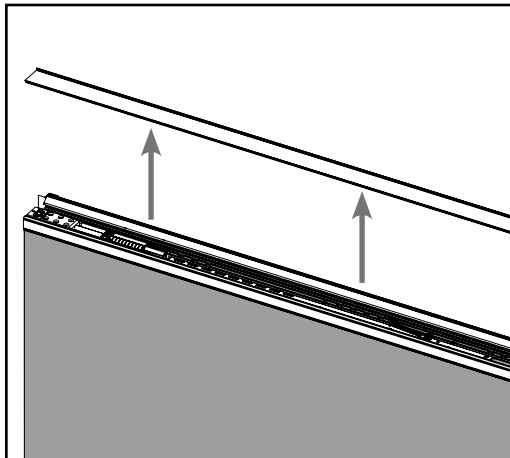
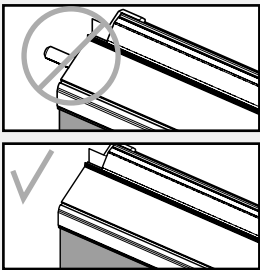

a. Remove the trim strip covering the upper bolt.

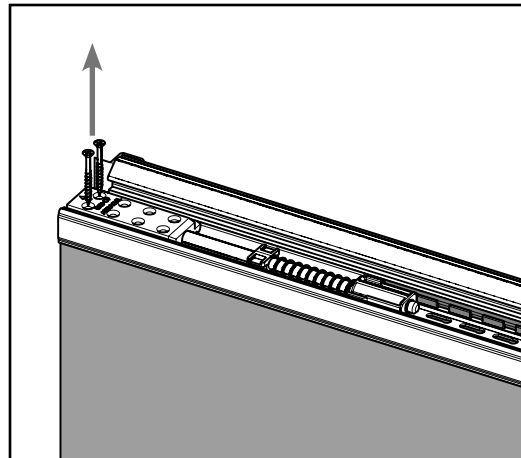

b. Remove the screws securing the upper bolt sleeve and set aside.

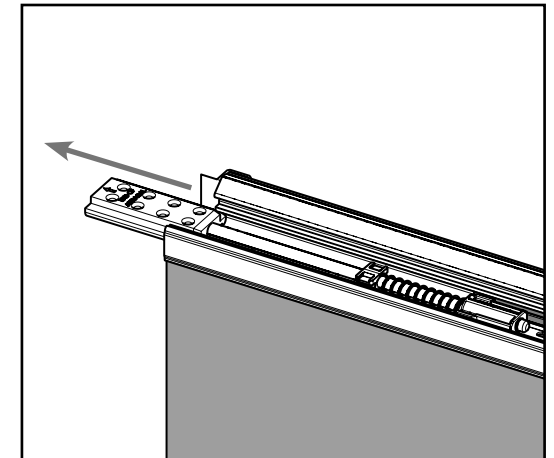

c. Slide the bolt sleeve out of the astragal and set aside.

STEP 2 (CONT.): REMOVE THE OLD BOLT FROM THE ASTRAGAL BODY

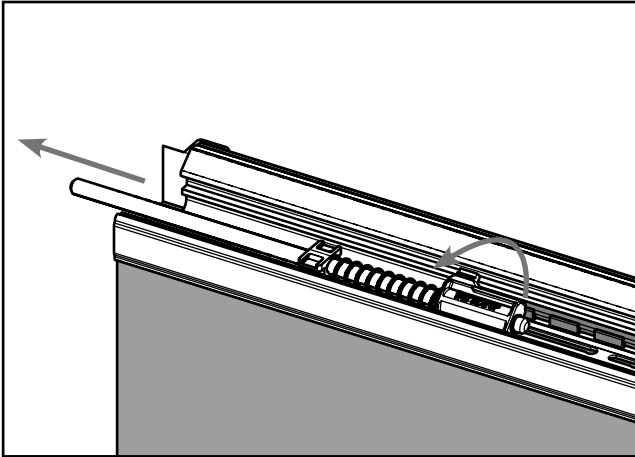

d. Rotate the bolt head out of the drive channel and slide the bolt out of the astragal body.

STEP 3: INSTALL NEW BOLT

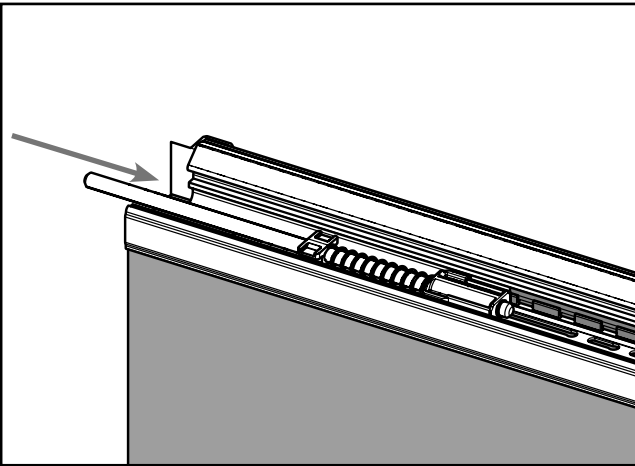

a. Slide the new bolt into the astragal body until the end of the bolt pin is flush with the end of the astragal.

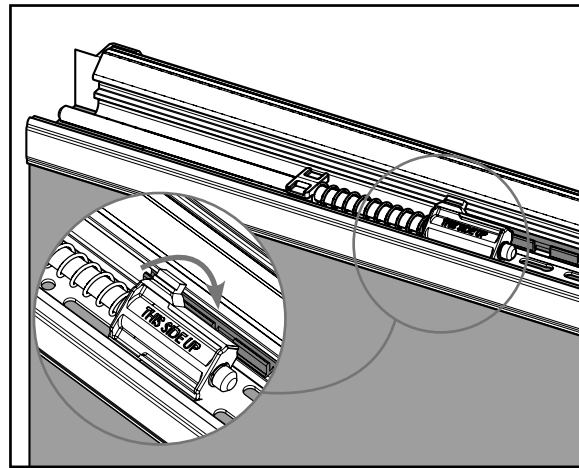

b. Check that the bolt head is in the correct orientation. "THIS SIDE UP" printing should be visible. Rotate the bolt head into the closest notch in the upper drive channel.

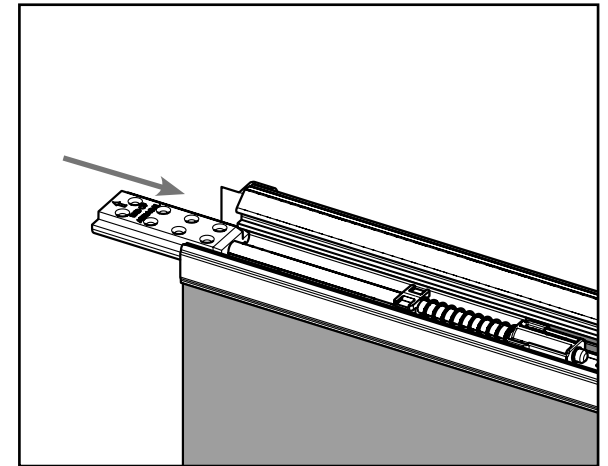

c. Return the upper bolt sleeve by sliding it into the astragal body, until it is flush with the end of the astragal.

STEP 3 (CONT.): INSTALL NEW BOLT

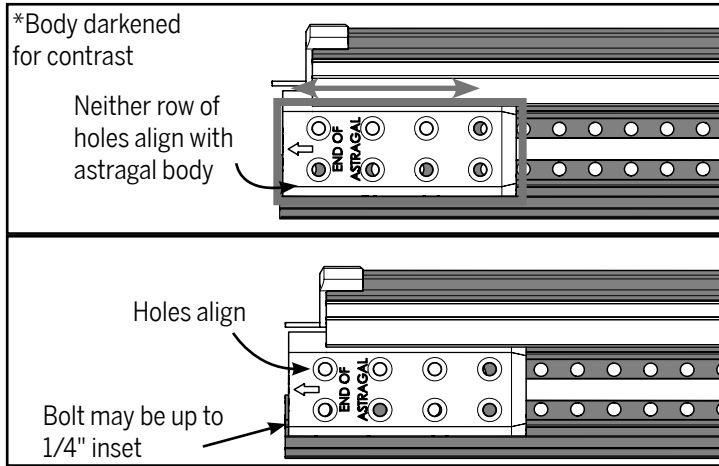

d. If the holes on the bolt sleeve do not initially align with the holes in the astragal body, adjust the location of the bolt sleeve to align the holes. The bolt sleeve may be up to 1/4" inset from the end of the astragal.

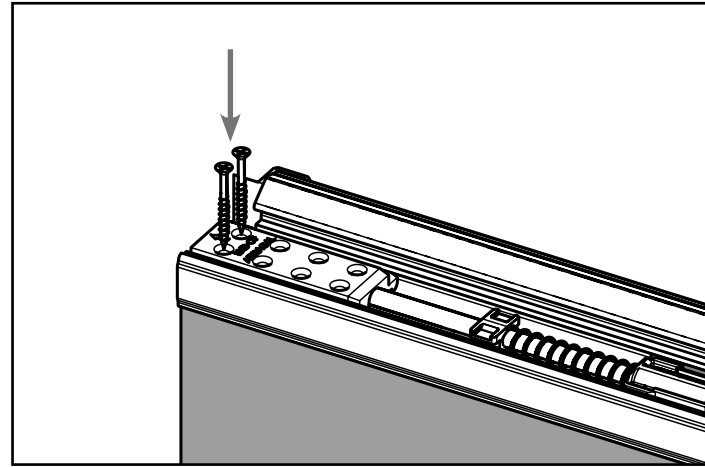

e. Insert screws into the holes in the bolt sleeve that align with the holes in the astragal.

STEP 4: CHECK BOLT OPERATION

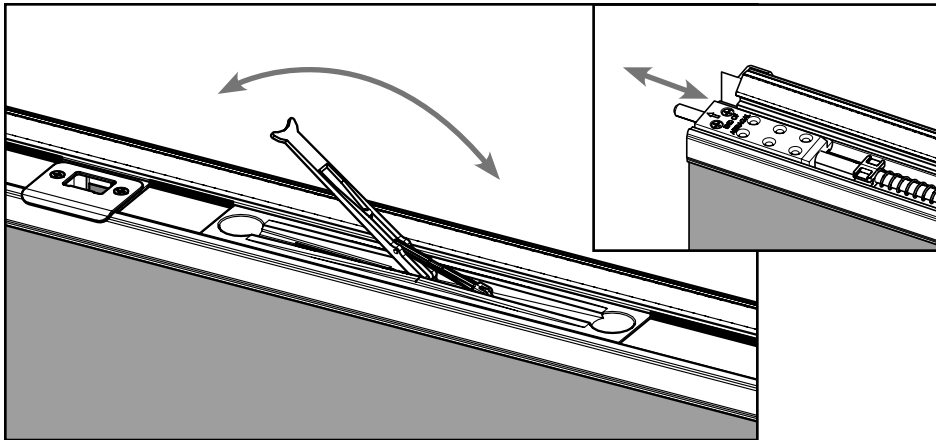

a. Engage the flip lever to confirm the upper bolt moves in and out smoothly.

b. If the bolt does not operate smoothly, check for bolt obstructions and ensure screws in the astragal are not overtightened. The top of the screw should be just flush with the astragal body.

STEP 5: REINSTALL THE DOOR PANEL

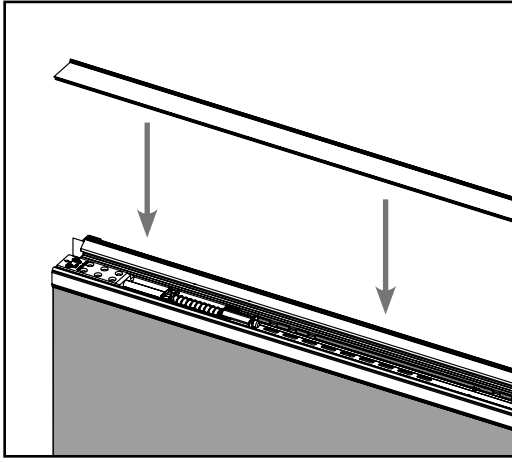

a. Replace the trim strip previously removed from the astragal body.

Note: The sealing fin on the trim strip should be directly next to the weatherstrip.

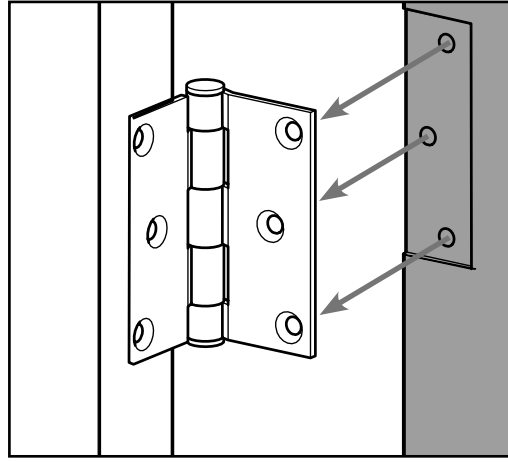

b. Reinstall the inactive door panel by screwing the door panel back to the hinges.

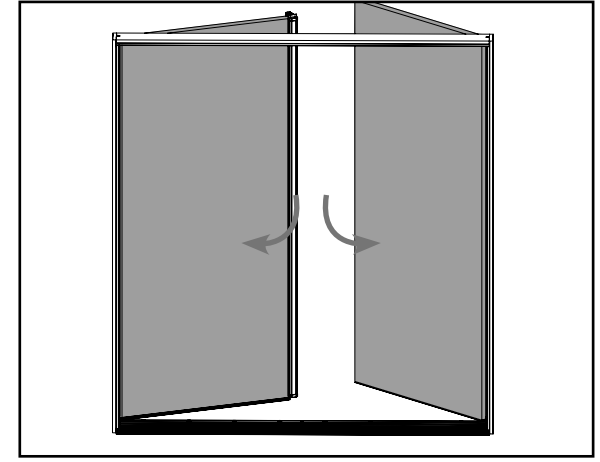

c. Close the inactive door and lock the bolts to ensure the bolts contact the header and sill receivers properly.