

Ultimate Flip Lever™ Astragal Lower Flush Bolt

Replacement Instructions

Tools Required:



Phillips
Screwdriver

Recommended Parts for Lower Flush Bolts:

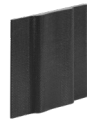

Endura Simple Solution
Corner Pad

Product Reference Guide

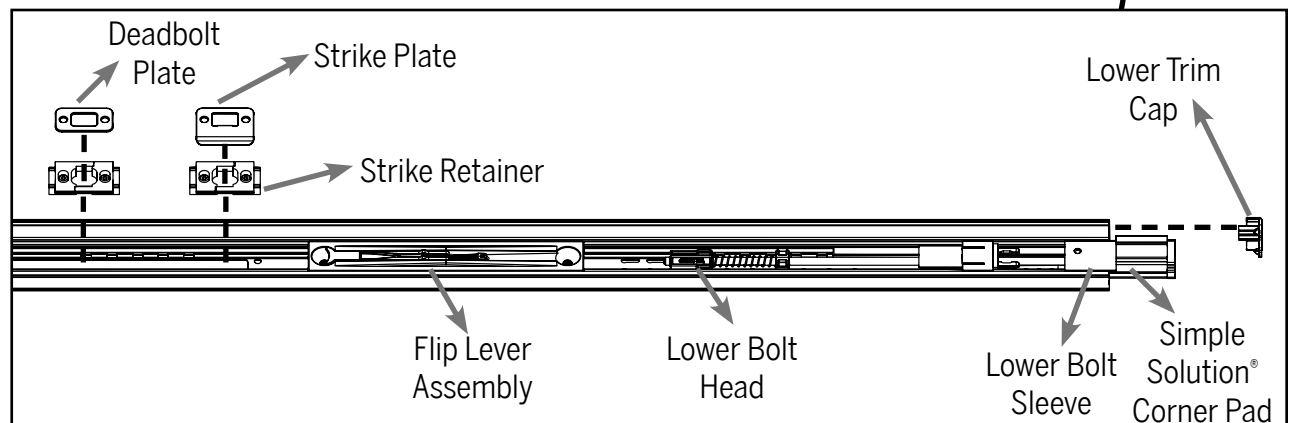
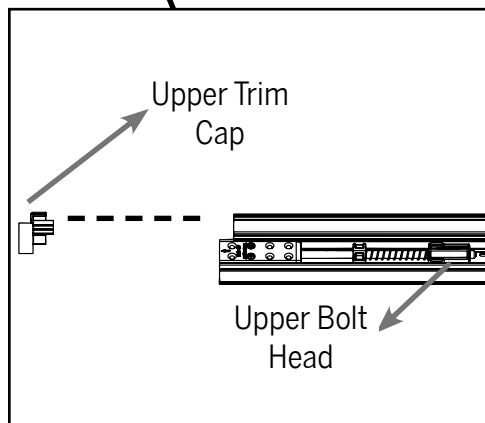
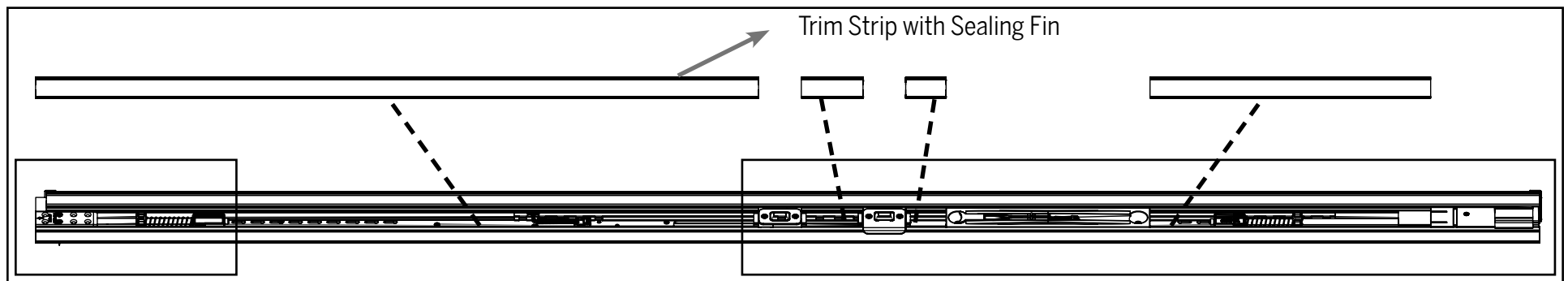

STEP 1: REMOVE THE INACTIVE DOOR PANEL FROM THE JAMB

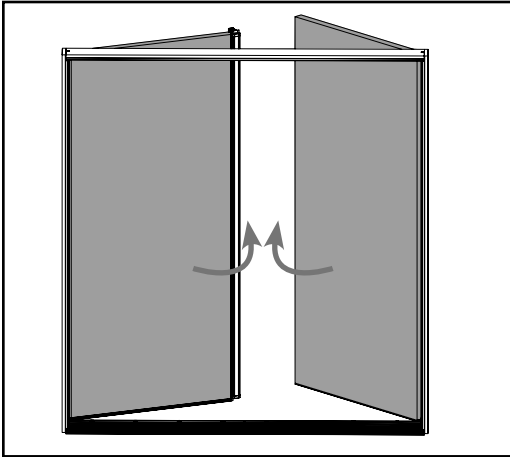

a. Open both door panels to access the hinges of the inactive door panel.

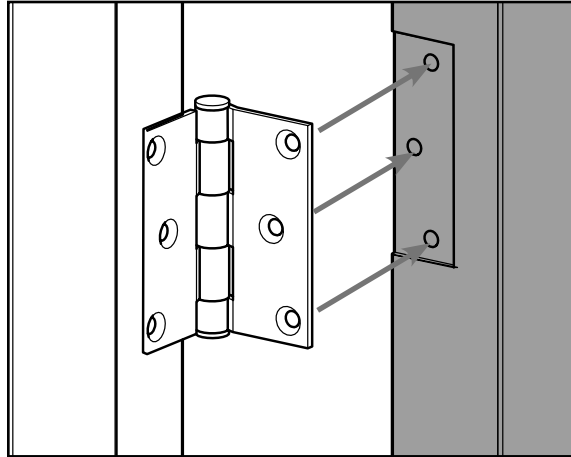

b. Remove screws and detach the inactive door panel from the hinges.

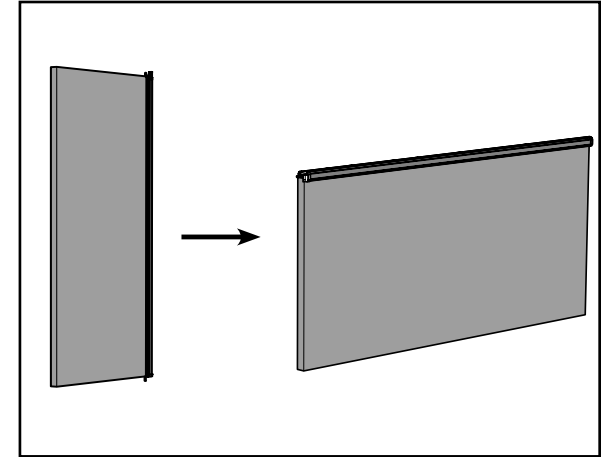

c. Place the door panel horizontally against a strong support to access the astragal.

STEP 2: REMOVE THE OLD BOLT FROM THE ASTRAGAL BODY

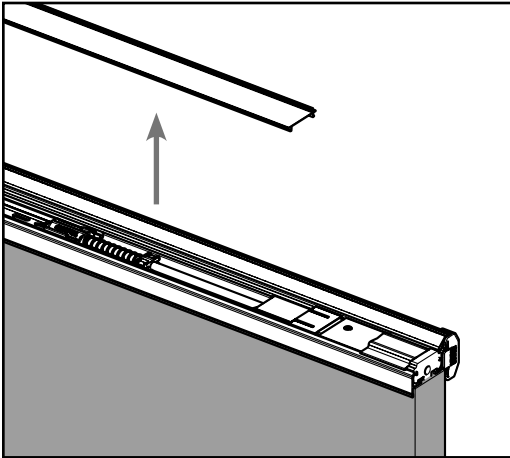

a. Remove the trim strip covering the lower bolt and set aside.

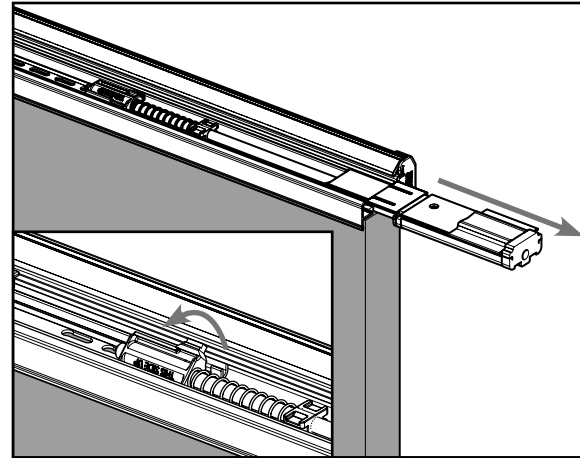

b. Rotate the bolt head out of the drive channel to freely slide the bolt out of the astragal. Discard the bolt.

STEP 3: INSTALL NEW BOLT

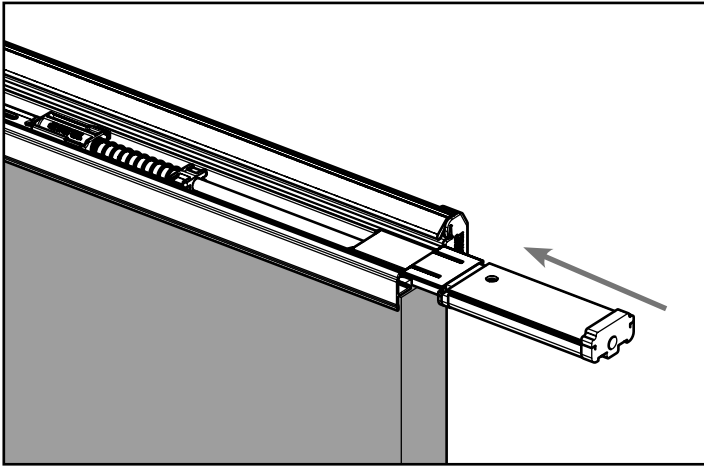

a. Slide the new bolt into the astragal body until the end of the bolt sleeve is flush with the end of the astragal.

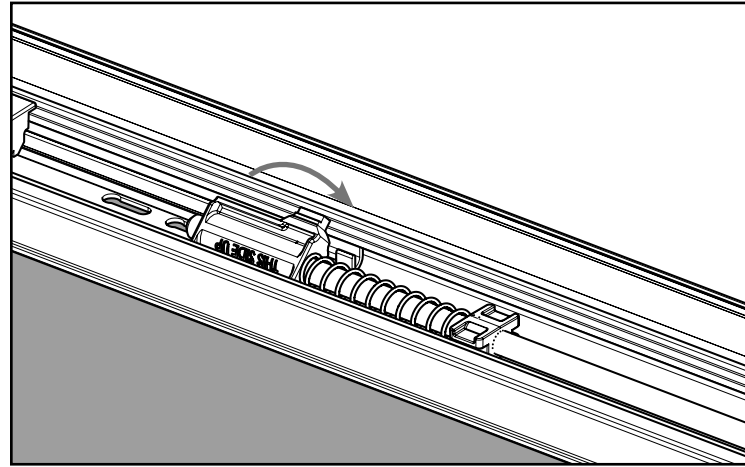

b. Check that the bolt head is in the correct orientation. "THIS SIDE UP" printing should be visible. Rotate the bolt head into the upper drive channel.

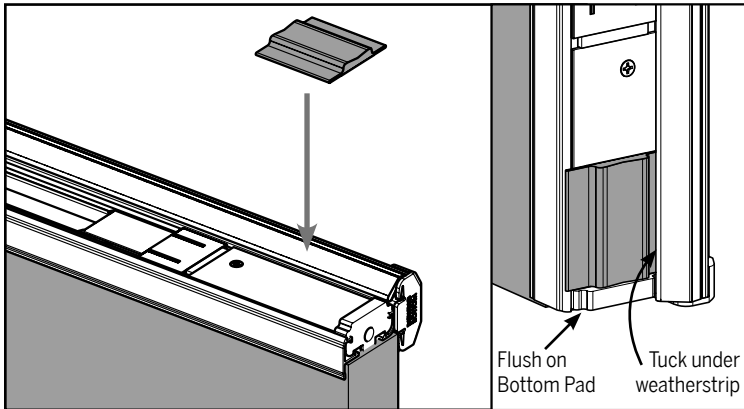

c. Install a new corner pad (purchased separately). Corner pads should be installed flush against the bottom pad and tucked under the weatherstrip.

STEP 4: CHECK BOLT OPERATION

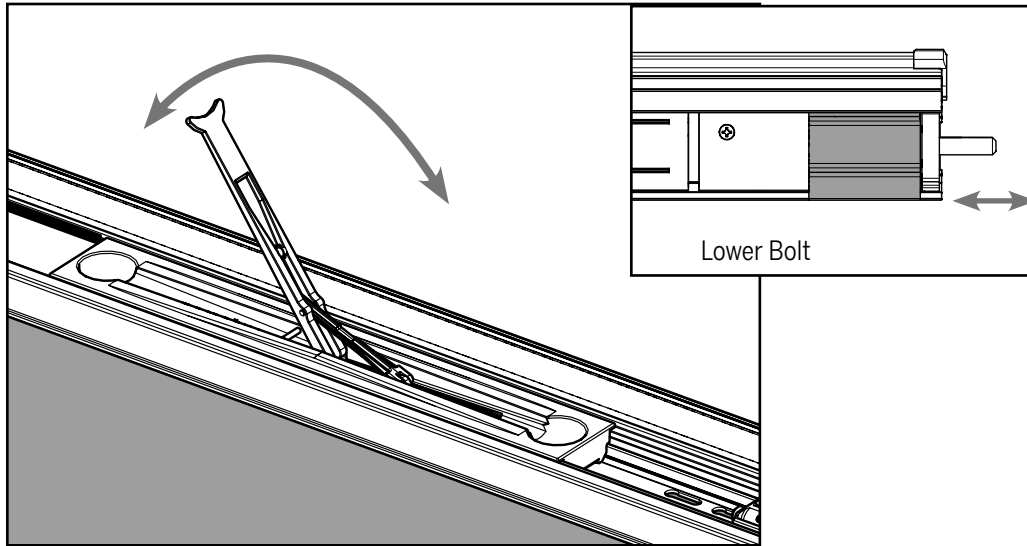

a. Operate the flip lever and ensure the lower bolt is properly engaged. If the lower bolt does not freely move, the lever may need to be cycled several times.

STEP 5: REINSTALL THE DOOR PANEL

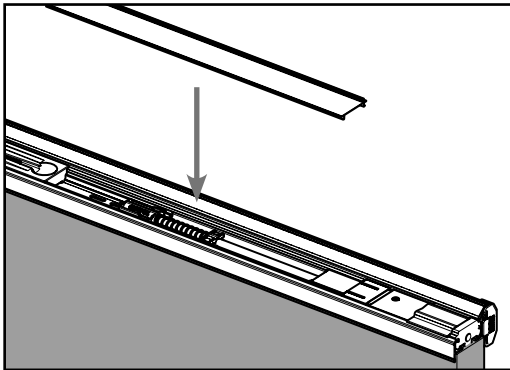

a. Replace the trim strip previously removed from the astragal body.

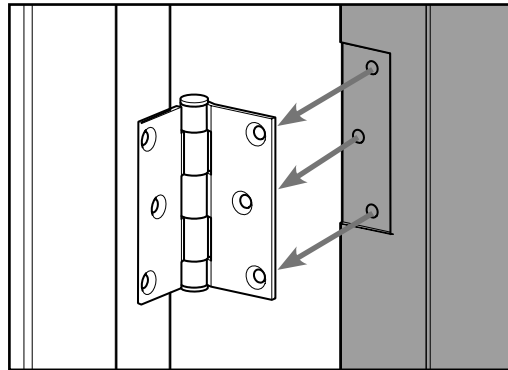

b. Reinstall the inactive door panel by screwing the door panel back to the hinges.

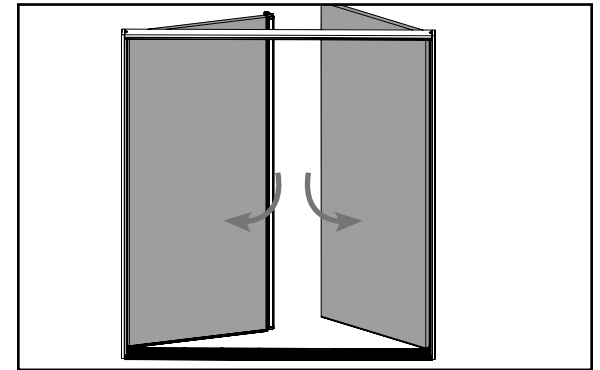

c. Close the inactive door and lock the bolts to confirm proper operation.