

Multi-Point Astragal Flush Bolt

Replacement Instructions

Tools Required:



Phillips
Screwdriver

Recommended Parts for Lower Flush Bolts:

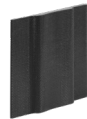

Endura Simple Solution®
Corner Pad

Product Reference Guide

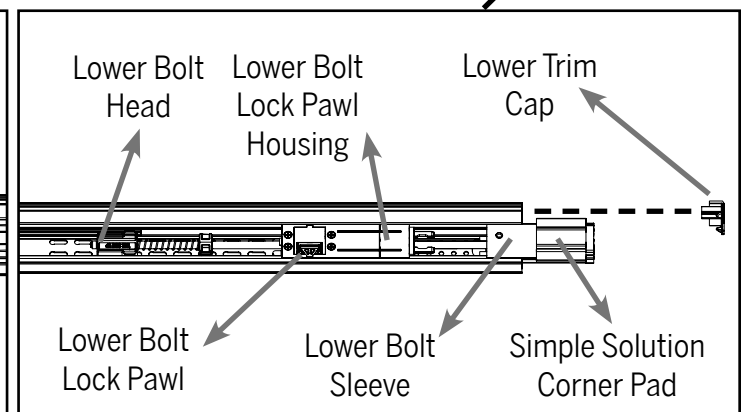
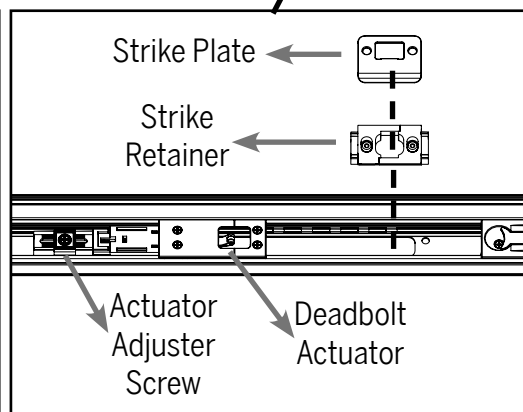
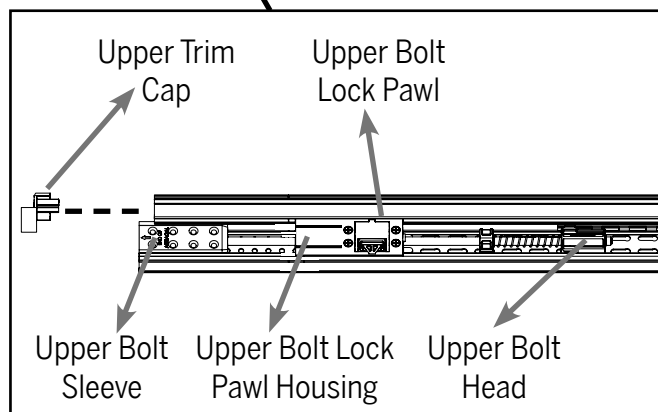
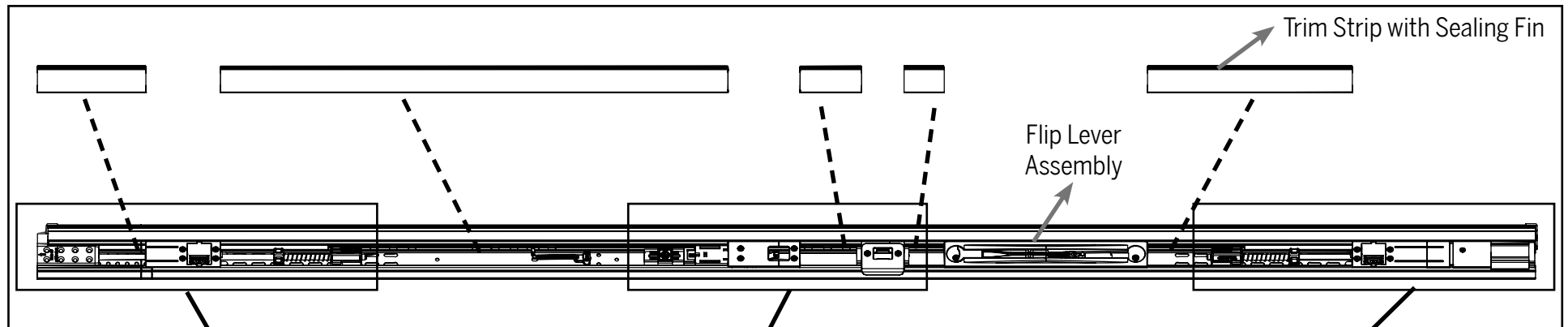

STEP 1: REMOVE THE INACTIVE DOOR PANEL FROM THE JAMB

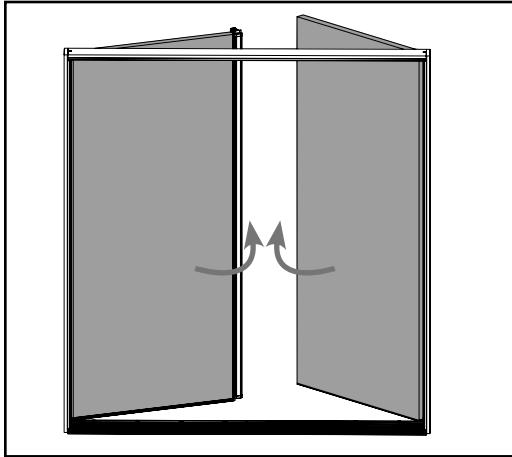

a. Open both door panels to access the hinges of the inactive door panel.

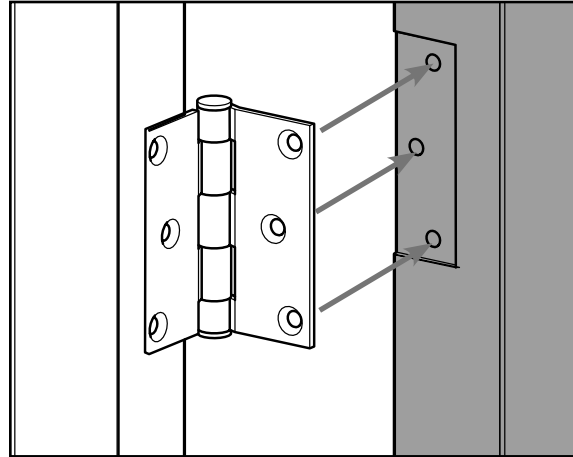

b. Remove screws and detach the inactive door panel from the hinges.

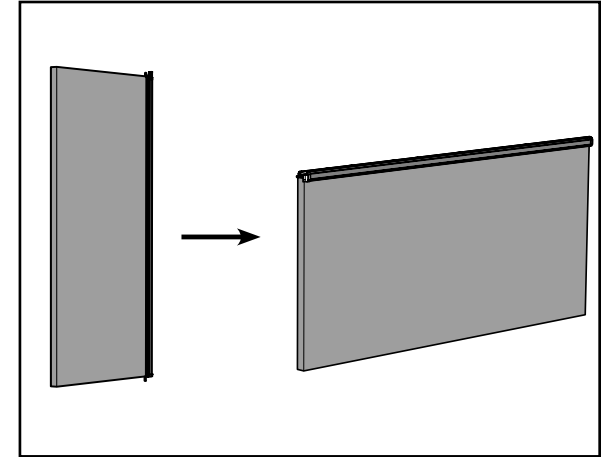

c. Place the door panel horizontally against a strong support to access the astragal.

STEP 2: REMOVE THE OLD BOLT FROM THE ASTRAGAL BODY

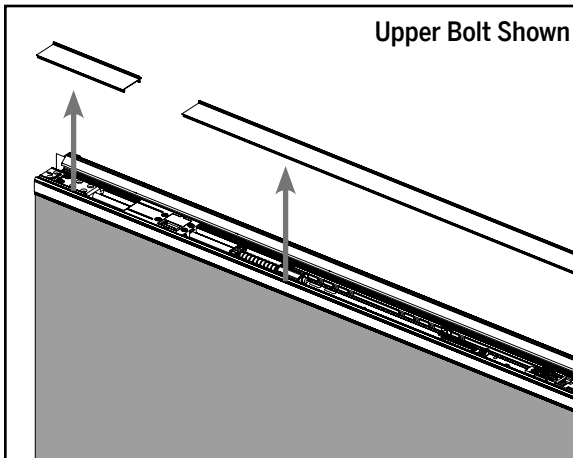

a. Remove the trim strip(s) covering the bolt being replaced and set aside.

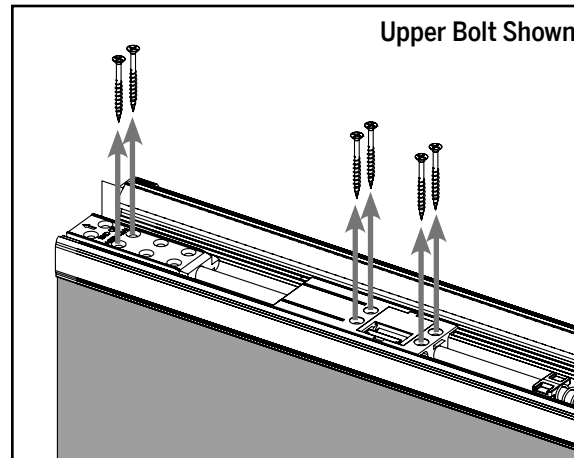

b. Remove the 6 screws from the upper bolt (4 around lock pawl and 2 from bolt sleeve) and set aside.

Note: The lower bolt will have a total of 5 screws to remove. (4 around lock pawl and 1 from bolt sleeve).

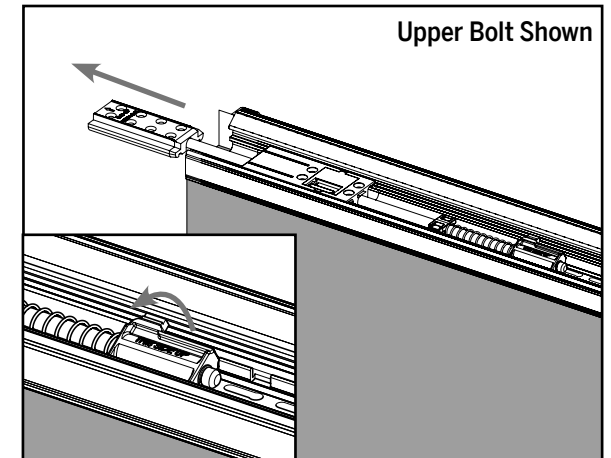

c. Rotate the bolt head out of the drive channel and slide the bolt and bolt sleeve out of the astragal. Discard the old bolt.

STEP 3: INSTALL NEW BOLT

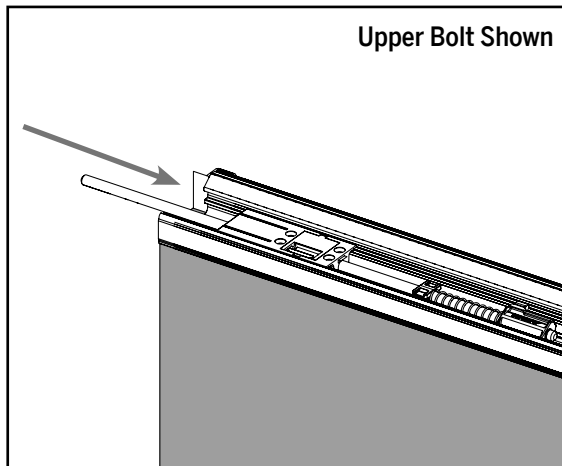

a. Slide the new bolt into the astragal body until the end of the bolt is flush with the end of the astragal.

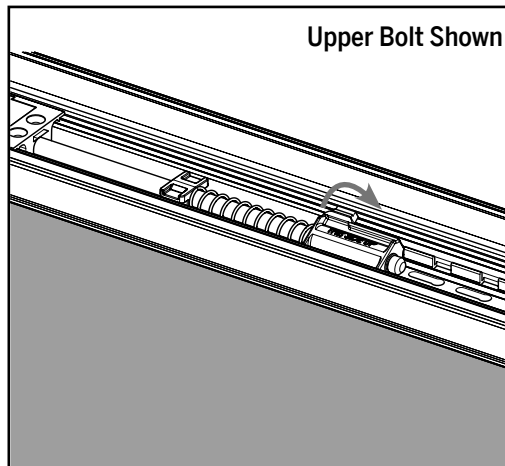

b. Check that the bolt head is in the correct orientation. "THIS SIDE UP" printing should be visible. Rotate the bolt head into the upper drive channel.

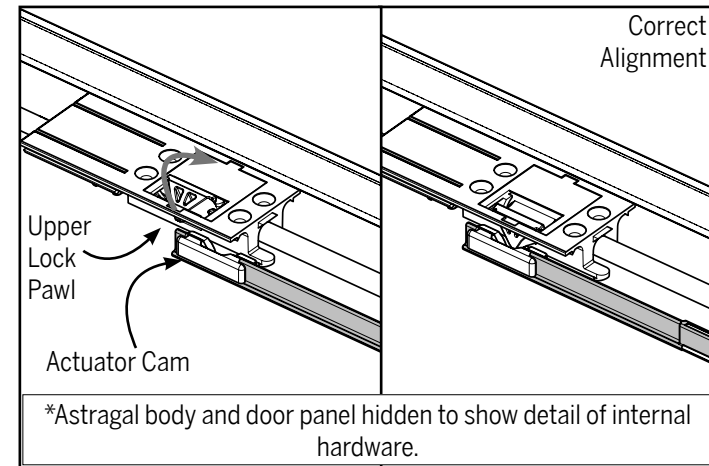

c. Adjust the T-bar to align the actuator cam with the lock pawl. Lift the upper lock pawl and slide the actuator cam under it, allowing it to mate with the lock pawl.

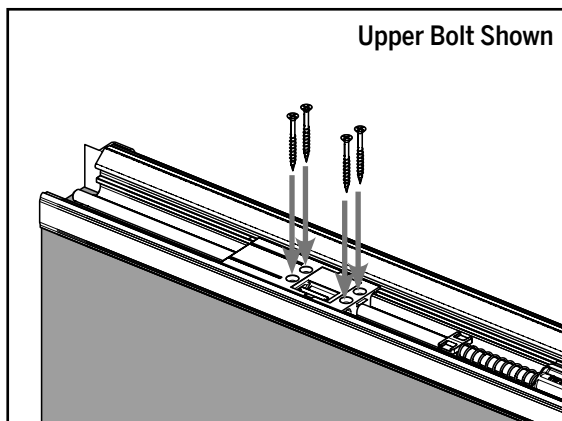

d. Reinstall the four screws surrounding the lock pawl.

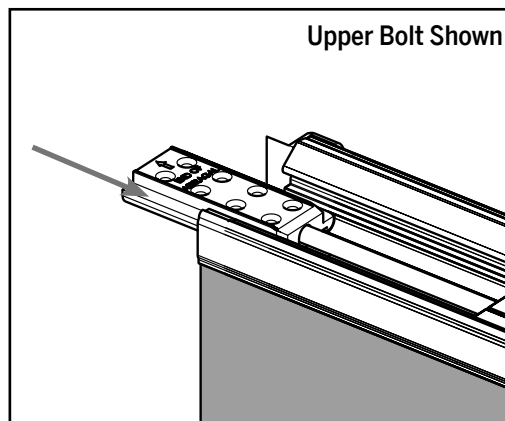

e. Slide the bolt sleeve into the astragal body, allowing it to slide along the bolt.

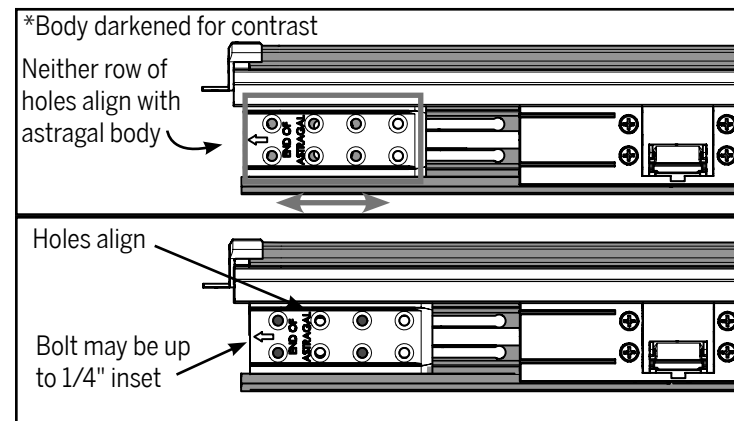

f. Adjust the bolt sleeve until the first or second row of holes aligns with the holes in the astragal body.

STEP 3 (CONT.): INSTALL NEW BOLT

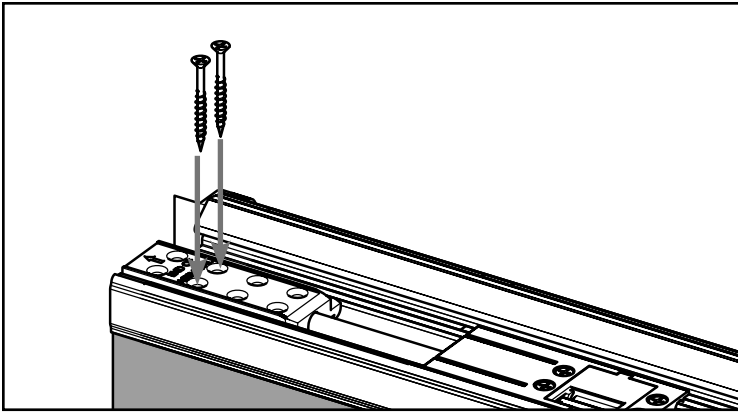

g. With the holes aligned on the bolt sleeve, insert the two screws previously removed through the hole and tighten.

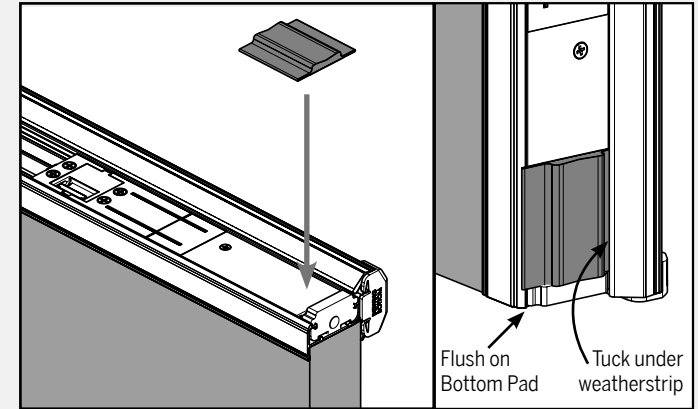

NOTE: If replacing the lower bolt, install a new corner pad (purchased separately) at this step.

Corner pads should be installed flush against the bottom pad and tucked under the weatherstrip.

STEP 4: CONFIRM BOLT AND LOCK PAWL OPERATION

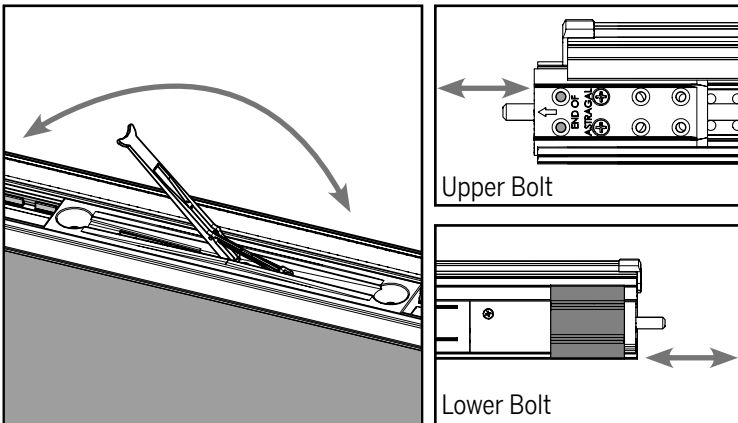

a. Operate the flip lever and ensure the bolt sleeve and pins move between engaged and disengaged positions.

NOTE: If the lower bolt does not freely move, the lever may need to be cycled several times.

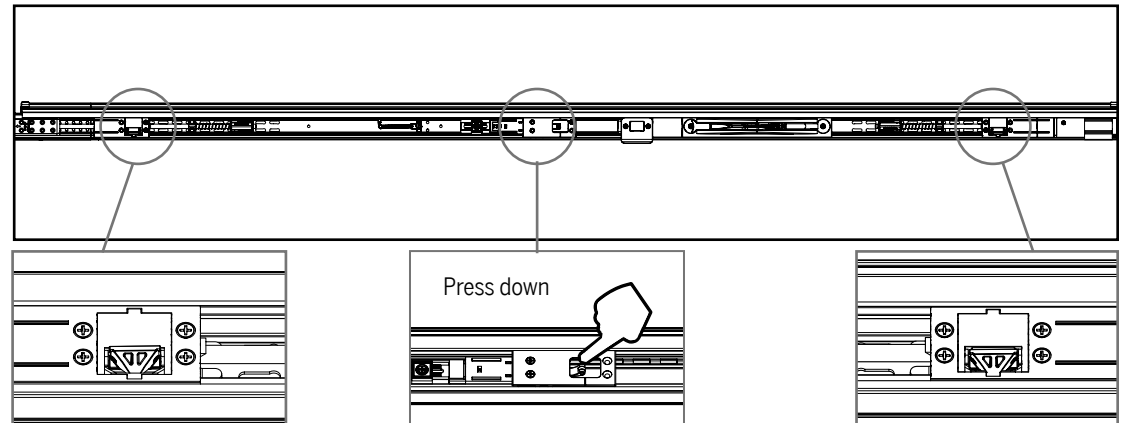

b. Operate the deadbolt actuator, ensuring the upper and lower lock pawls move between engaged and disengaged positions. Check that there is no binding between the lock pawls when the deadbolt actuator is fully depressed and that the pawls move at the same time.

STEP 5: REINSTALL THE DOOR PANEL

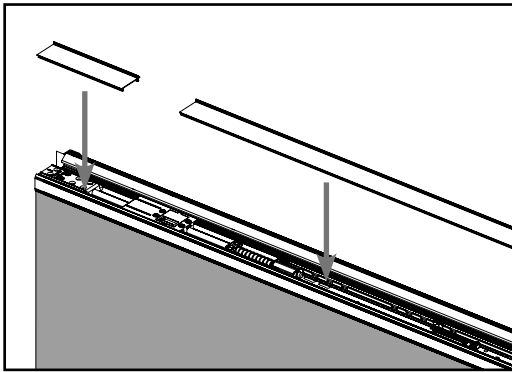

a. Replace the trim strip(s) previously removed from the astragal body.

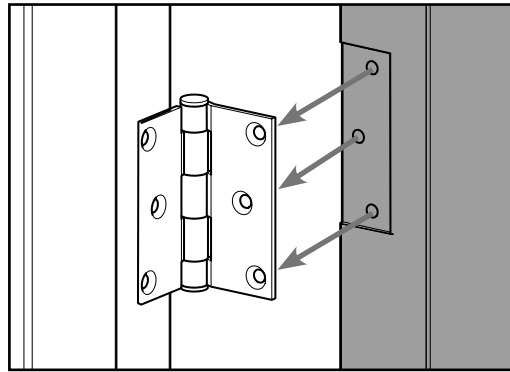

b. Reinstall the inactive door panel by screwing the door panel back to the hinges.

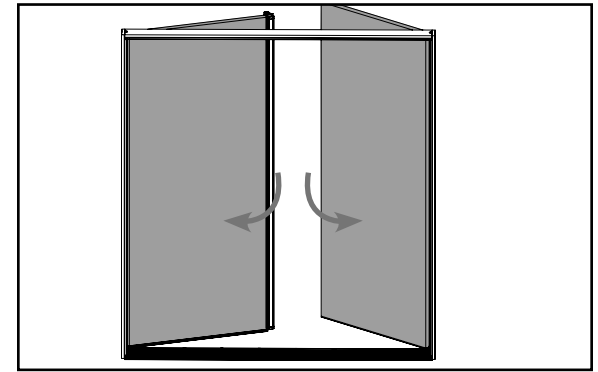

c. Close the inactive door and lock the bolts to confirm proper operation.