

Flip Lever Assembly

Replacement Instructions



8817 West Market Street
Colfax, NC 27235 | 800.334.2006
www.enduraproducts.com

Tools Required:

- Flathead Screwdriver
- Phillips Screwdriver
- Pencil/ Marker

Kit Includes:

- Flip Lever Assembly
- Mounting Screws (3)

Product Reference Guide

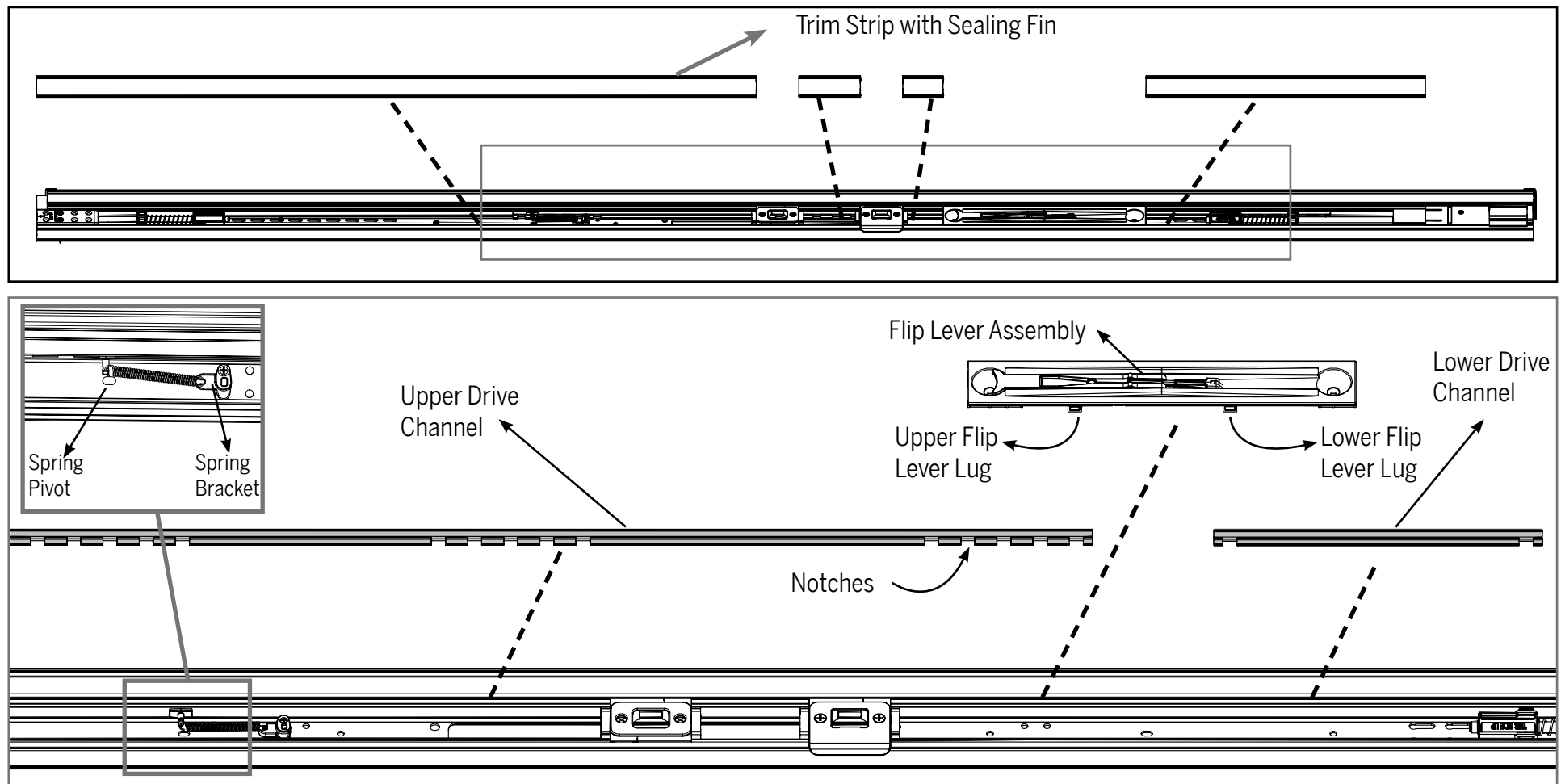

STEP 1: REMOVE THE INACTIVE DOOR PANEL FROM THE JAMB

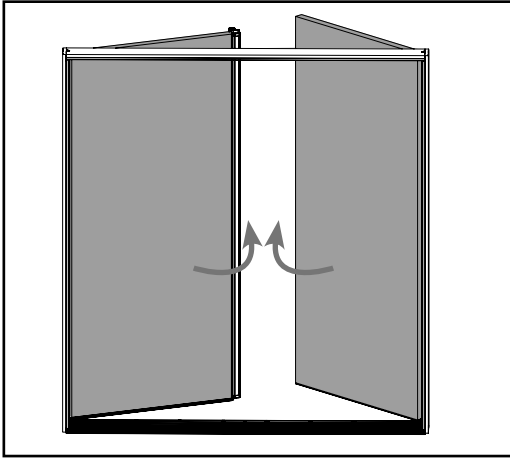

a. Open both door panels to access the hinges of the inactive door panel.

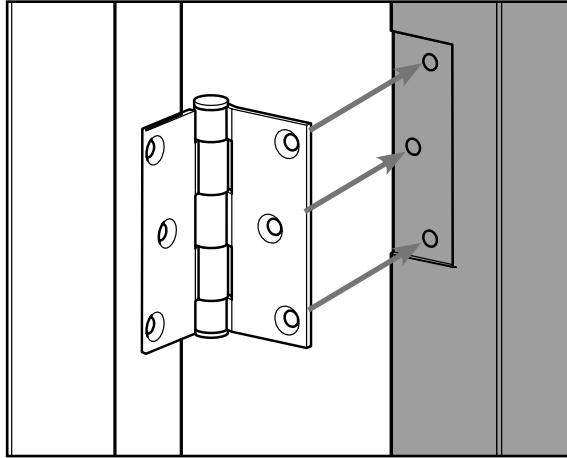

b. Remove screws and detach the inactive door panel from the hinges.

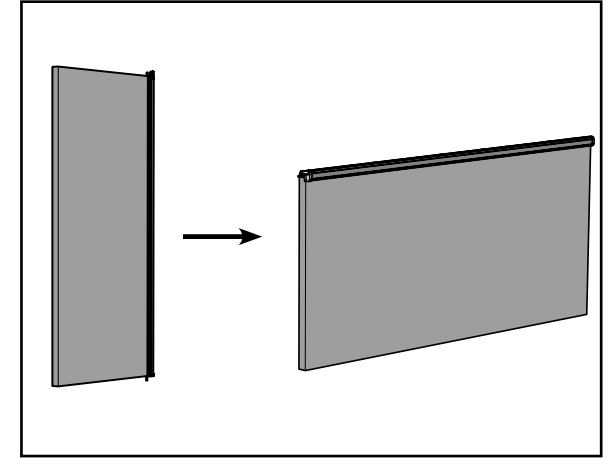

c. Place the door panel horizontally against a strong support to access the astragal.

STEP 2: REMOVE THE ASTRAGAL FROM DOOR PANEL

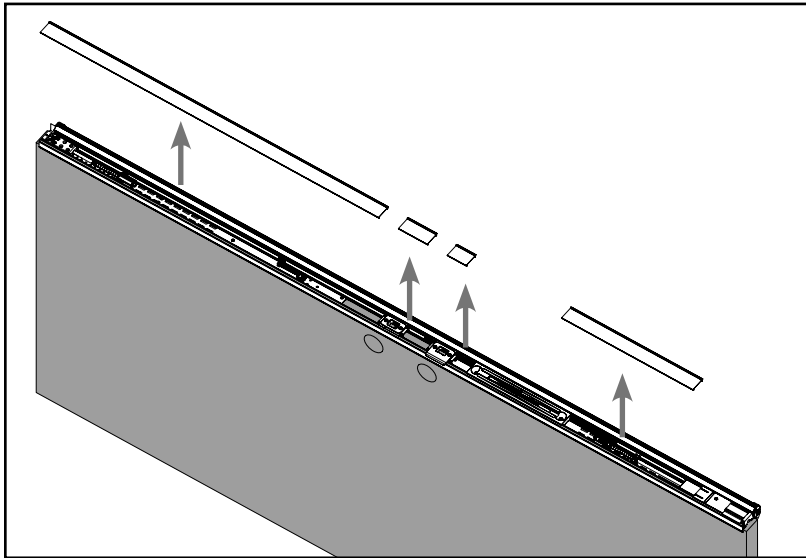

a. Remove the pieces of trim strip from the astragal and set aside.

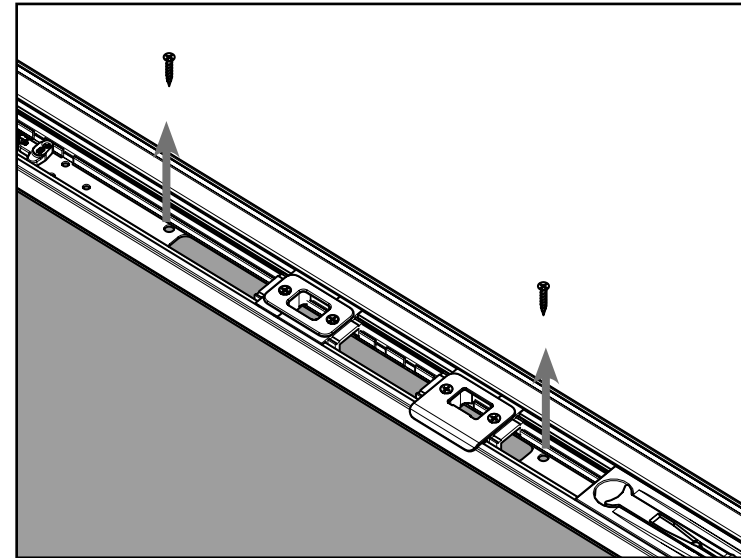

b. Remove the screws on either side of the strike and deadbolt plates that secure the astragal to the door panel.

STEP 2 (CONT.): REMOVE THE ASTRAGAL FROM DOOR PANEL

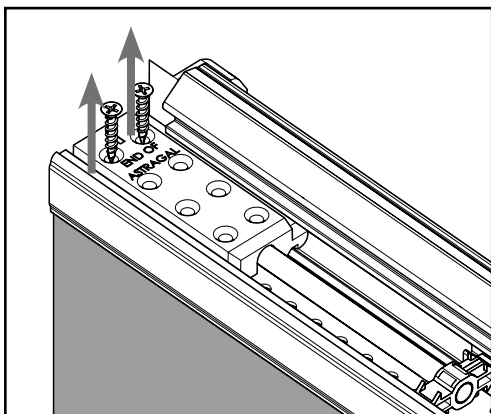

c. Remove the two screws on the upper bolt sleeve.

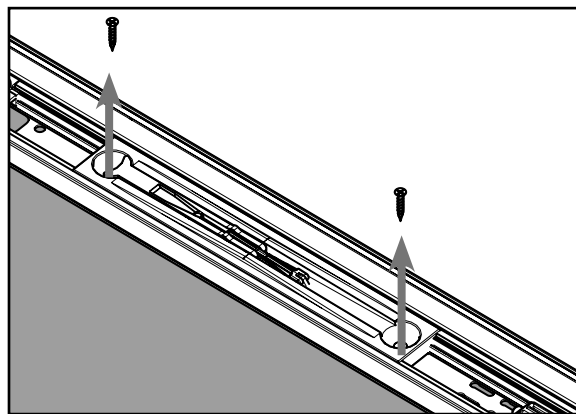

d. Remove the two screws from the flip lever assembly.

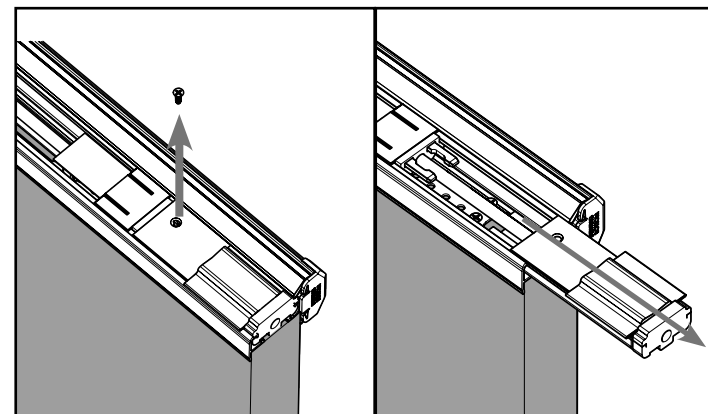

e. Remove the screw from the lower bolt sleeve. Slide the bolt sleeve out of the astragal and set aside.

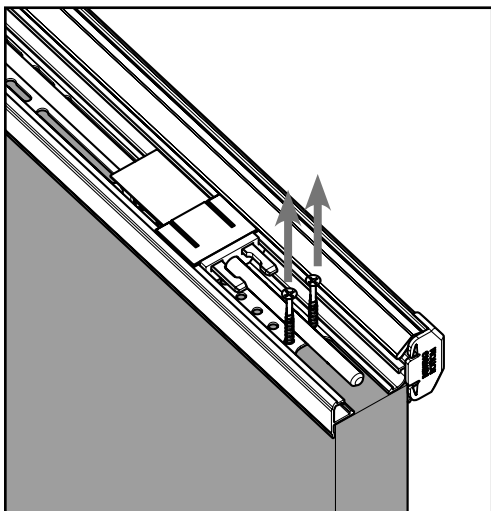

f. Remove the two screws next to the bolt pin above the U-shaped cutout in the astragal body.

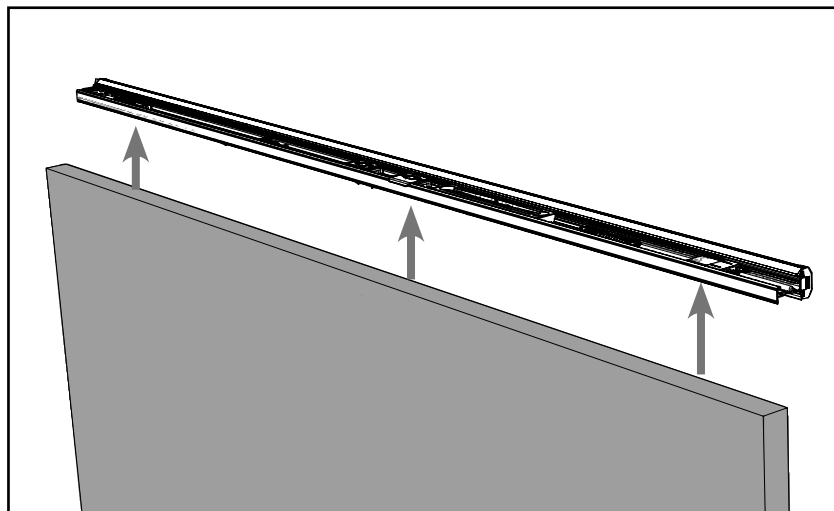

g. Lift the astragal off the door panel and set on a flat surface.

STEP 3: REMOVE THE FLIP LEVER ASSEMBLY TO BE REPLACED

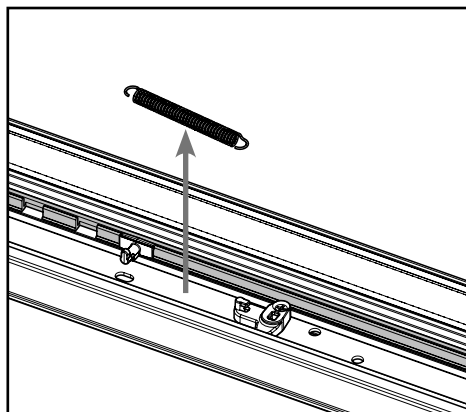

a. Disengage the spring from the spring bracket and spring pivot and set aside.

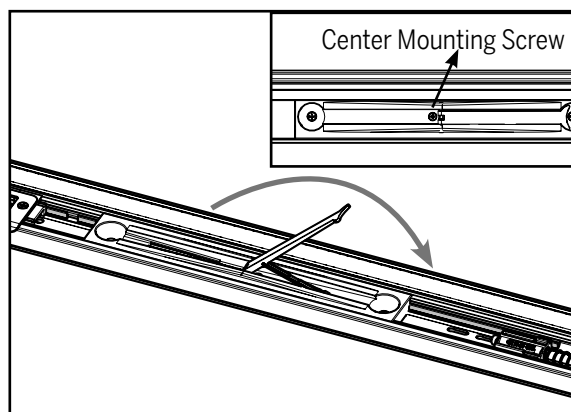

b. Move the flip lever into the locked position to access the center mounting screw.

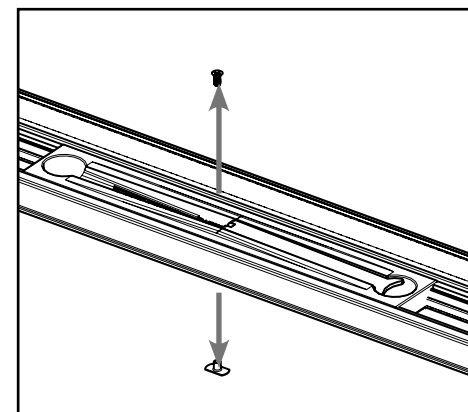

c. Remove the mounting screw and T-nut from the center of the flip lever assembly and set it aside.

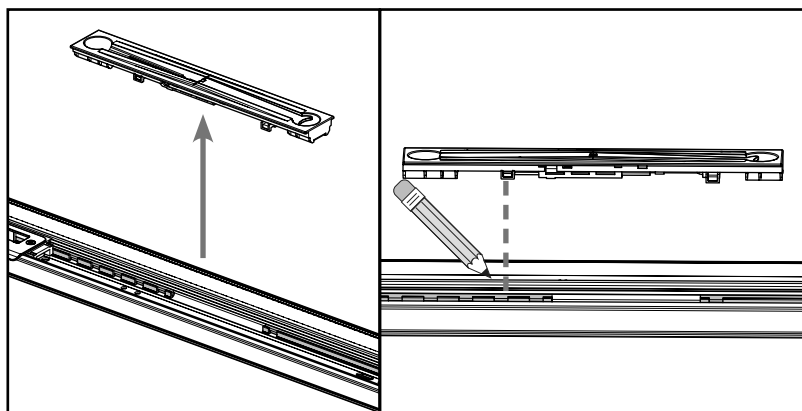

d. Remove the flip lever assembly from the astragal body by lifting it straight up from the astragal body. As you remove the flip lever assembly, mark the location on the astragal body where the upper flip lever lug aligns with a notch in the upper drive channel.

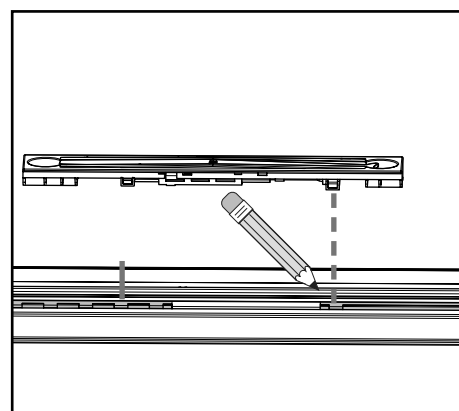

e. Make a mark on the astragal body where the lower flip lever lug aligns with the notch in the lower drive channel.

STEP 4: INSTALL THE NEW FLIP LEVER ASSEMBLY

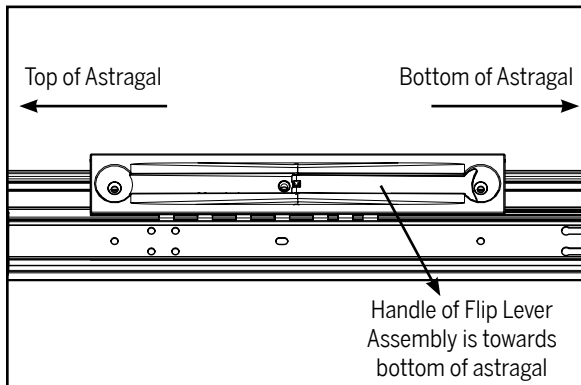

a. Align the new flip lever assembly with the astragal body so that the handle arm points towards the bottom of the astragal.

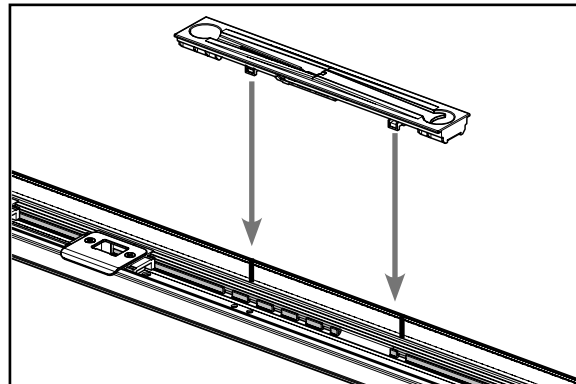

b. Insert the new flip lever assembly into the astragal body, ensuring the flip lever lugs align with the marks made on the astragal body in Steps 3d and 3e. Ensure the flip lever assembly sits flush in the body with the lugs securely inserted in the notches.



Do not operate the flip lever until the screw is reinserted.

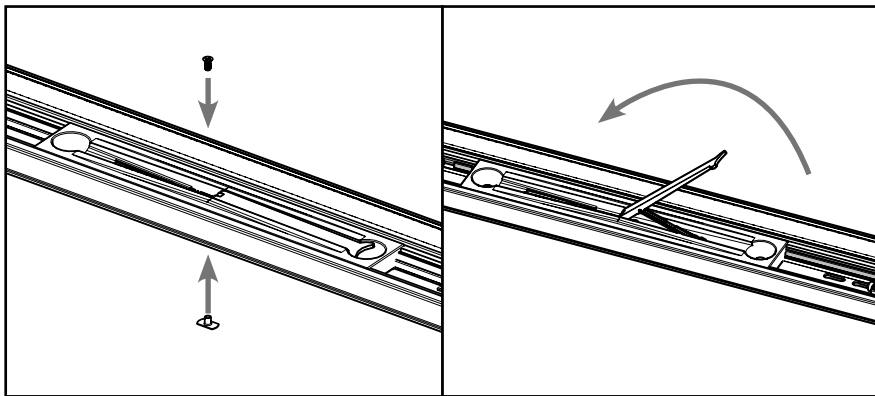

c. Holding the T-nut into place below the flip lever, reinstall the center mounting screw. When secured, disengage the flip lever.

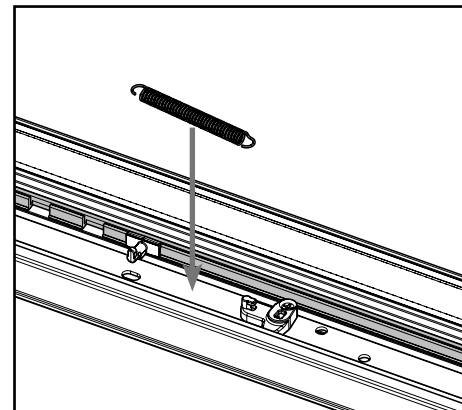

d. Reinstall the spring between the spring pivot and spring bracket.

STEP 5: REINSTALL ASTRAGAL ON DOOR PANEL

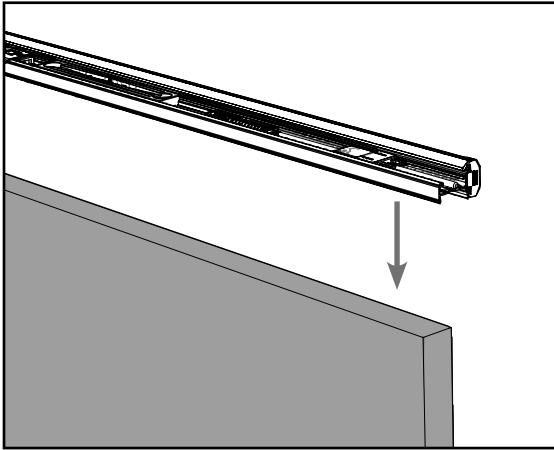

a. Place the astragal back on the door panel. Ensure the bottom of the astragal is flush with the end of the door panel.

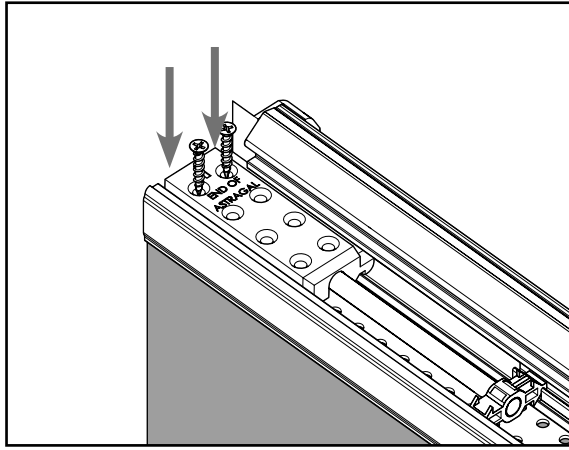

b. Install the two screws previously removed from the upper bolt sleeve.

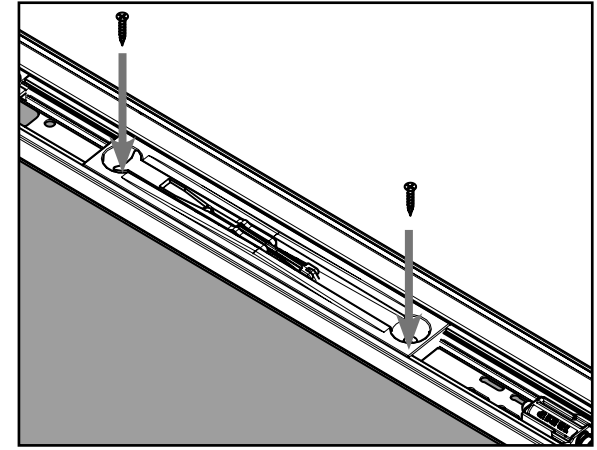

c. Install the two screws previously removed from the flip lever assembly.

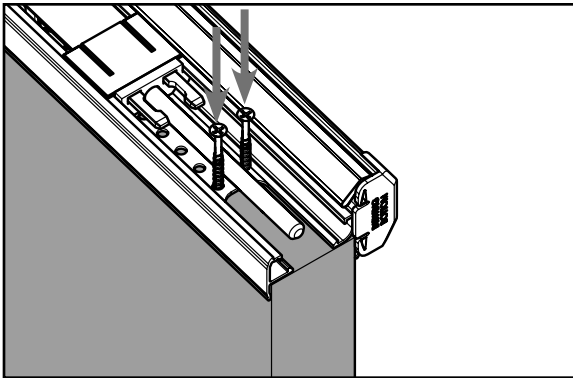

d. Install the two screws on either side of the bolt pin above the U-Shaped cutout in the astragal body.

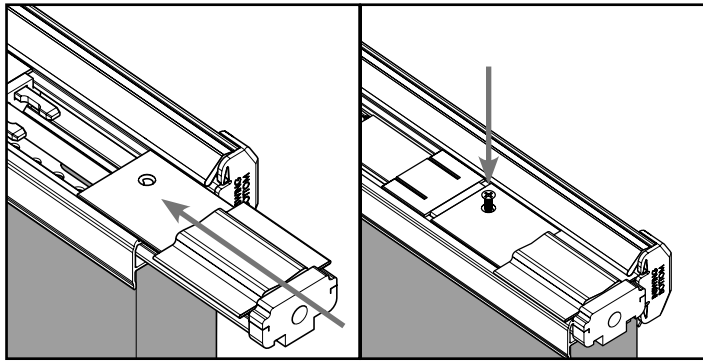

e. Return the bolt sleeve onto the lower bolt and reinstall the screw securing the bolt sleeve.

STEP 6: CONFIRM OPERATION

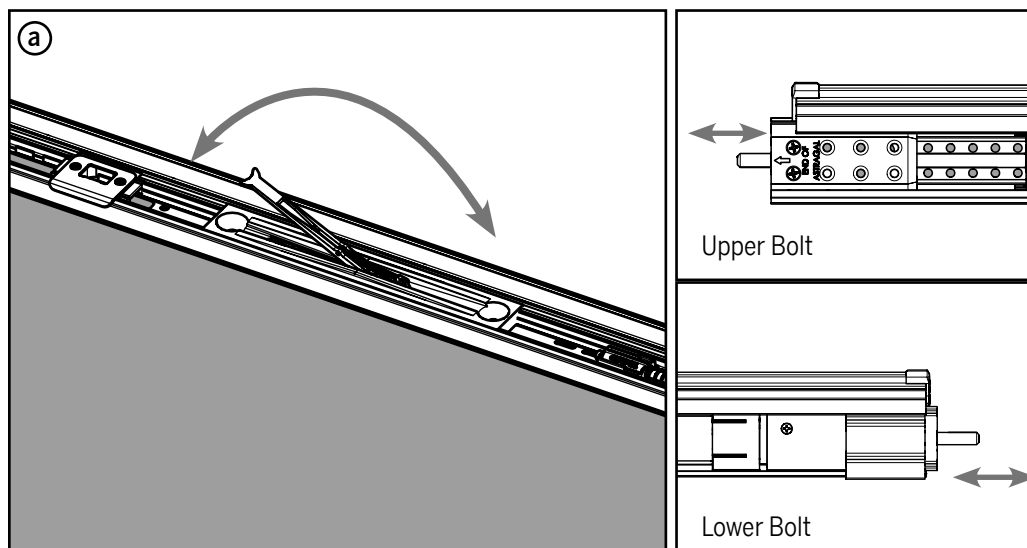

a. Engage the flip lever and ensure both the upper and lower bolts move in and out smoothly.

b. If the bolts **do not** operate smoothly:

- Check for bolt obstructions.
- Check that the screws in the astragal are not overtightened in the astragal body. The top of the screw should be flush with the astragal body.
- If the lever operation is difficult, slightly loosen the screws securing the flip lever assembly.

STEP 7: REINSTALL THE DOOR PANEL

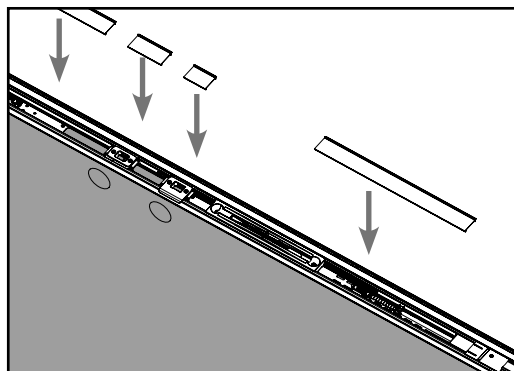

a. Replace the trim strips previously removed from the astragal body.

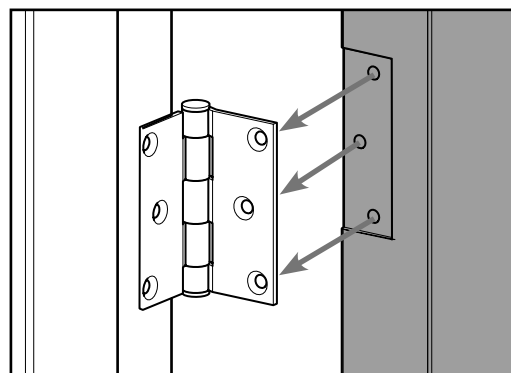

b. Reinstall the inactive door panel by screwing the door panel back to the hinges.

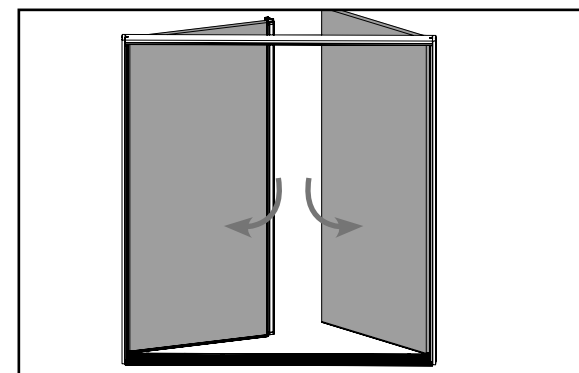

c. Close the inactive door and lock the bolts to confirm proper operation.